

# APPENDIX





APPENDIX C – TRANSPORTATION WORKSHEET

The following transportation Worksheet shall be filled out in association with Sections 3.1.1 and 3.1.2 of this Code.

Project Name: \_\_\_\_\_ By: \_\_\_\_\_

Date: \_\_\_\_\_ Title: \_\_\_\_\_

Property Address or Legal Description (lot, block, subdivision): \_\_\_\_\_ Address: \_\_\_\_\_

Phone: \_\_\_\_\_

Fax: \_\_\_\_\_

Existing Zoning: \_\_\_\_\_

E-mail: \_\_\_\_\_

Developer: \_\_\_\_\_

Part One: All Developments

Provide the following information, to the best of your knowledge, for all projects:

- 1. Has a previous Transportation Impact Study (TIS) been prepared for the site? Yes \_\_\_\_ No \_\_\_\_
- 2. Are there proposed street intersections included with this development? Yes \_\_\_\_ No \_\_\_\_
- 3. Are there existing intersections affected by the development action(s)? Yes \_\_\_\_ No \_\_\_\_  
If yes, which? \_\_\_\_\_
- 4. What is the proposed year of build-out? \_\_\_\_\_
- 5. Will the project be phased? Yes \_\_\_\_ No \_\_\_\_  
If yes, what is the proposed phasing plan? \_\_\_\_\_
- 6. Are there other proposed developments in the study area? \_\_\_\_\_
- 7. Are there other committed roadway improvements in the area? \_\_\_\_\_
- 8. Are there proposed roadway improvements to be provided by the Applicant with this project? \_\_\_\_\_  
\_\_\_\_\_
- 9. Are there bicycle and pedestrian attractions near the development? (Existing or imminent within 1320' of the site. This distance may be increased up to 1.5 miles for residential projects near existing or proposed school sites.)  
Yes \_\_\_\_ No \_\_\_\_

**Part Two: Non-residential Development**

Provide the following information, to the best of your knowledge, for all non-residential projects:

**A. Existing Use:**

1. Description of existing land use: (if none, proceed with Part B): \_\_\_\_\_
2. Existing building area (square footage) for above use(s): \_\_\_\_\_
3. Number of employees on site each day: \_\_\_\_\_
4. Daily trip ends for employees [multiply line 3 by the number 4]: \_\_\_\_\_
5. Number of customers on site each day: \_\_\_\_\_
6. Daily trip ends for customers [multiply line 5 by the number 2]: \_\_\_\_\_
7. Number of vendors on site each day (include trash, UPS, etc.): \_\_\_\_\_
8. Daily trip ends for vendors [multiply line 7 by the number 2]: \_\_\_\_\_
9. Total vehicular daily trip ends [line 4 plus line 6 plus line 8]: \_\_\_\_\_
10. How many Company Vehicles are used daily: \_\_\_\_\_
11. How many Company Vehicles will be parked on site: \_\_\_\_\_
10. Source of trip generation data (circle one): ITE, business records, traffic engineer, personal estimates, other: \_\_\_\_\_  
\_\_\_\_\_. Attach documentation to support your data.
11. Number of accesses, width, and type of drive surface exiting onto the public street(s) from this property: \_\_\_\_\_
12. Number of pedestrians visiting site each day: \_\_\_\_\_
13. Number of bicyclists visiting site each day: \_\_\_\_\_
14. Do sidewalks exist along all street(s) adjacent to property? Yes \_\_\_\_ No \_\_\_\_
15. Is property adjacent to a major collector or arterial street? Yes \_\_\_\_ No \_\_\_\_

**B. Proposed Use:**

1. Description of proposed land use: \_\_\_\_\_
2. Proposed building area (square footage) for above use(s): \_\_\_\_\_
3. Anticipated number of employees on site each day: \_\_\_\_\_
4. Daily trip ends for employees [multiply line 3 by the number 4]: \_\_\_\_\_

5. Anticipated number of customers on site each day: \_\_\_\_\_
6. Daily trip ends for customers [multiply line 5 by the number 2]: \_\_\_\_\_
7. Anticipated number of vendors on site each day: \_\_\_\_\_
8. Daily trip ends for vendors [multiply line 7 by the number 2]: \_\_\_\_\_
9. Total vehicular daily trip ends [line 4 plus line 6 plus line 8]: \_\_\_\_\_
10. Source of trip generation data (circle one): ITE, business records, traffic engineer, personal estimates, other: \_\_\_\_\_  
 \_\_\_\_\_ . Attach documentation to support your data.
11. Proposed number of accesses onto the public street(s) from this property (does NOT include any existing accesses proposed to remain for use): \_\_\_\_\_
12. Number of existing accesses proposed to remain and be used: \_\_\_\_\_
13. Number of pedestrians visiting site each day: \_\_\_\_\_
14. Number of bicyclists visiting site each day: \_\_\_\_\_
15. Do sidewalks exist along street(s) adjacent to property? Yes \_\_\_\_ No \_\_\_\_
16. Property is not adjacent to a major collector or arterial street as shown on the City's Master Transportation Plan.  
 Yes \_\_\_\_ No \_\_\_\_
17. Is a zone change requested? Yes \_\_\_\_ No \_\_\_\_
18. If yes, the existing zone is \_\_\_\_\_, and the proposed zone is \_\_\_\_\_ .

If the total new trips (the difference between the daily trip ends calculation for any existing use and the total daily trip ends calculation for any existing use and the total trip ends calculated for the proposed use) is less than 500 and if peak hour and/or daily traffic counts demonstrate that the existing traffic plus the site generated traffic volumes are within the limits by these standards, you (the applicant) may request a waiver of the Transportation Impact Study submitted requirements by signing below.

Signature: \_\_\_\_\_ Date: \_\_\_\_\_

Transportation Impact Study Required: _____	Transportation Impact Assessment Required: _____	TIS Waived: _____
By: _____		Date: _____

**Part Three: Residential Development**

Fill out the table below and indicate in the table the number of dwelling units or access changes proposed for the type(s) of residential development included in your development. If the number of dwelling units and changes in access are less than the thresholds established above and if peak hour and/or daily traffic counts demonstrate that the existing traffic plus the site generated traffic volumes are within the limits set by City policy, you (the applicant) may request a waiver from the TIS requirement by signing your name below. Provide the following information, to the best of your knowledge, for all residential projects:

NUMBER	RESIDENTIAL DEVELOPMENT TYPE
	Single-family detached/dwelling units
	Multi-family dwelling units in duplex, tri-plex, or four-plex structures
	Multi-family dwelling units in structures containing five or more units
	Access changes onto a collector or arterial roadway

Signature: \_\_\_\_\_

Date: \_\_\_\_\_

Transportation Impact Study Required: _____	Transportation Impact Assessment Required: _____	TIS Waived: _____
By: _____		Date: _____

**APPENDIX D [RESERVED]**



**APPENDIX E PEDESTRIAN AND BICYCLE GUIDELINES**

E-1	Intent
E-2	Responsibilities
E-3	Standards
E-4	Specifications
E-5	Site Designs General Connectivity Requirements
E-6	Design Features and Accommodations for Pedestrians
E-7	Pedestrian Crossings at High-use Pedestrian Areas
E-8	Mid-block Crossings
E-9	Crosswalk Locations and Warrants
E-10	Elevated Crosswalk to Refuge Island
E-11	Bulbouts/Curb Extensions
E-12	Modern Roundabouts
E-13	Design, Location, and Type of Bicycle Parking Facilities

**E-1 INTENT**

Sidewalks and bicycle facilities are integral to the transportation system. The Pedestrian Level of Service Guidelines are intended to ensure that pedestrian interests and bicycle interests are considered in all analysis of the study, analysis, planning, design, engineering, and construction of transportation facilities. They are also intended to ensure that any flexibility in the transportation standards of this code is executed in a manner that is most appropriate to the context and site, and that it properly balances pedestrian and bicycle interests with other transportation interests.

**E-2 RESPONSIBILITIES**

The builder on the lot is responsible for sidewalk construction. Where sidewalks are not directly related to a lot, the construction of sidewalks is the responsibility of the developer. A certificate of occupancy will not be issued until sidewalks required by the approved site plan are constructed and approved.

**E-3 STANDARDS**

Sidewalks shall be provided for any portion of a site which abuts a roadway. All sidewalks shall be in the public right-of-way. Sidewalk width will be as specified in Article 4 of this code. When a sidewalk abuts angled parking such that there will be vehicular overhang, the sidewalk shall be a minimum of six feet in width. Curb ramps shall be provided wherever an accessible route crosses a curb as per the current ADA Accessibility Guidelines. Driveways shall also be constructed in accordance with current ADA Accessibility Guidelines. Where there is adequate right-of-way, the construction of the sidewalk independent of the curb and gutter section is required. The area between the sidewalk and the back of the curb shall be appropriately landscaped. Sidewalks in the Downtown Development District shall conform to streetscape recommendations set forth in the *Cheyenne Downtown Streetscape Design and Improvement Standards*, available at the Cheyenne MPO Office.

**E-4 SPECIFICATIONS**

Sidewalk construction and removal shall be in accordance with the current *City of Cheyenne and Board of Public Utilities Construction Standards and Specifications*. Curb ramps are illustrated in Standard Drawings of the specifications.

NOTE: The requirements of the Americans with Disabilities Act for sidewalks, curb ramps and protruding objects change from

time to time. Persons designing or building sidewalks should verify with the City Engineer that they are using the current criteria. Sidewalks shall be a minimum of 4 inches thick, except where traversed by driveways, in which case the driveway thickness shall govern.

## E-5 SITE DESIGNS GENERAL CONNECTIVITY REQUIREMENTS

The following sections identify general connectivity standards, features, and accommodations for pedestrians.

- A. Safe and convenient pedestrian access from the development site should be provided to existing designated trails or greenways located on or adjacent to the development site. On-site connections should be made at points necessary to provide direct pedestrian travel from the development to major pedestrian destinations located within the adjacent neighborhood(s), including but not limited to parks, schools, commercial districts, and transit stops.
- B. In order to provide direct pedestrian connections to these adjacent destinations, the City may require additional sidewalks, walkways, or bike paths not associated with a street, the extension of a sidewalk from the end of a cul-de-sac to another street or walkway and/or connections between developments.
- C. Paths, when built to the standards of the Greater Cheyenne Area Greenway and in 20' public right-of-way, will be maintained by City Parks and Recreation Staff. All commercial retail, office, industrial and residential apartment developments should provide for the following design elements:
  1. Wide, safe front sidewalk;
  2. Direct pedestrian sidewalks to surrounding properties, transit stops, and sidewalks along the surrounding street;
  3. Locate major entry driveways away from front of stores where pedestrians must cross, and enhance them with pedestrian facilities such as sidewalks and cross walks;
  4. Canopies in front of stores to offer weather protection; and
  5. Pedestrian plazas.

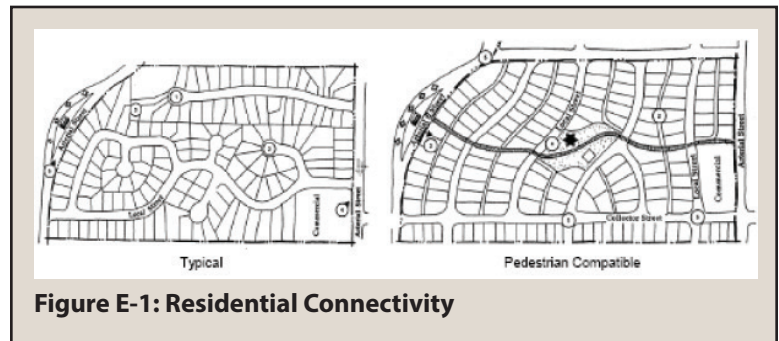

**Figure E-1: Residential Connectivity**

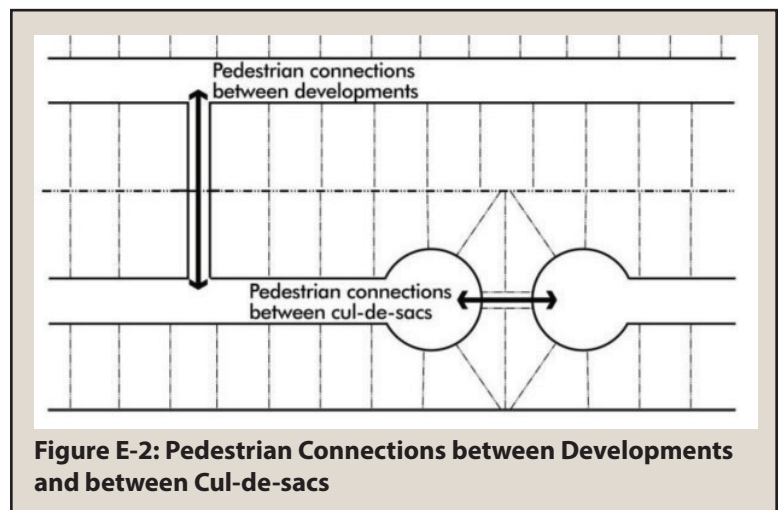

**Figure E-2: Pedestrian Connections between Developments and between Cul-de-sacs**



**Figure E-3: Commercial Retail Shopping Center**

- D. The following exhibits provide examples of typical developments as compared to developments with pedestrian-compatible improvements. These examples illustrate the same development yield for the site, illustrating that good pedestrian connection and development opportunities are compatible and efficient.

E. When necessary to assure the public’s safety in using on-site or connecting pedestrian sidewalks, the City may require the developer to provide on-site or off-site pedestrian overpasses, underpasses, or traffic signalization. These connections are particularly important for providing pedestrian connections to transit stops, schools and parks.

F. Each development should provide and contribute to an on-site system of pedestrian walkways. To the maximum extent feasible, on-site walkways should provide the most direct access route between the intended points of travel. Specifically, pedestrian connections should be provided to and between the following points:

1. The primary project entrance or entrances to each building housing a principal use,
2. Any sidewalk or walkway on adjacent properties that extends to the boundaries shared with the development,
3. Any public sidewalk system along the perimeter streets adjacent to the development site, existing or planned transit stations, shelters, stops and park-n-ride locations, and
4. On-site amenities such as landscape/hardscape, benches, pedestrian lighting.
5. All on-site and public sidewalks, pedestrian walkways, or trails should have and maintain a minimum unobstructed pathway width of at least 4.5 to 6 feet, and as otherwise specified by the street design standards.

## E-6 DESIGN FEATURES AND ACCOMMODATIONS FOR PEDESTRIANS

To the maximum extent feasible, the following guidelines should be incorporated in the design of all new developments to ensure safe and convenient pedestrian access into and within the site, with minimum potential for conflict with motor vehicles. These design elements complement the five measures of pedestrian level of service: directness, continuity, street crossings, visual interest and amenity, and security.

A. **Directness.** Developers should provide and encourage direct pedestrian connections by adhering to the following guidelines.

1. Provide direct pedestrian connections to transit, schools, activity areas, and public facilities.

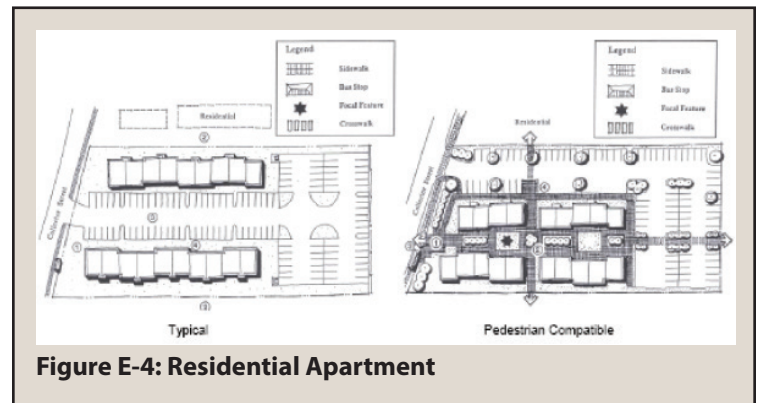

Figure E-4: Residential Apartment

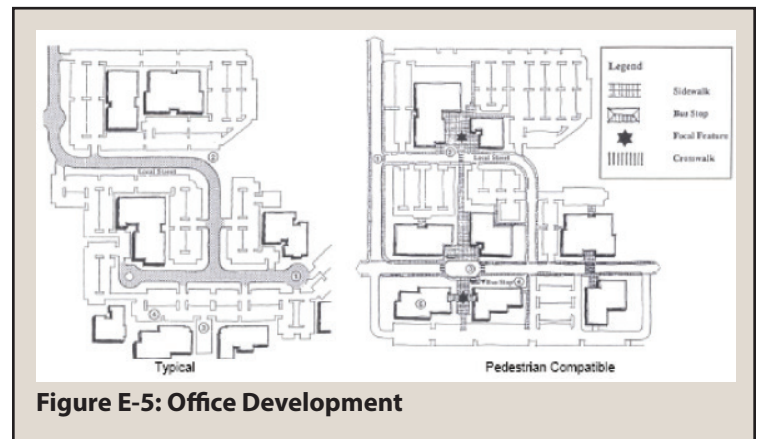

Figure E-5: Office Development

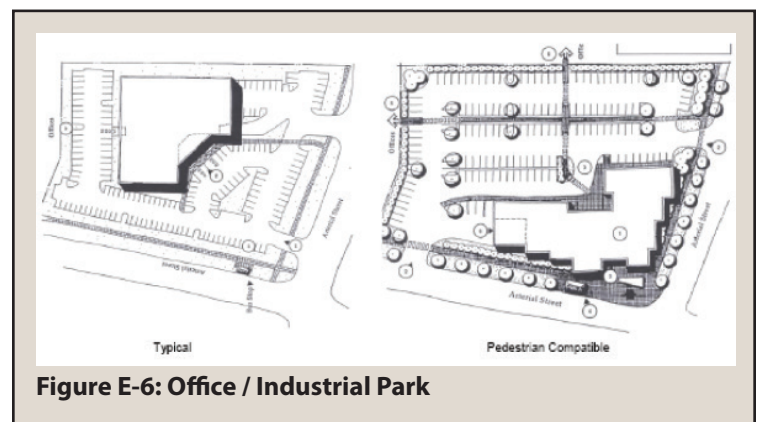

Figure E-6: Office / Industrial Park

2. Provide visible connections to key pedestrian destinations. Align and locate buildings, roadways, and open space so that pedestrians can see their destinations before arriving there.
3. Provide clearly marked building entries as viewed from the street. Entries from parking lots should be subordinate to those related to the street. Buildings should be sited in

ways to make their entries or intended uses clear to pedestrians.

4. The location and pattern of streets, buildings, and open space must facilitate direct pedestrian access.
  5. Use light fixtures to provide direct indication for pedestrian traffic. Light fixtures should be of shielded type with flat level lenses when appropriate.
  6. Ensure that sidewalk uses, such as outdoor cafes, in high-use retail pedestrian settings, are compatible with direct pedestrian access to buildings and other destinations.
  7. Avoid barriers that separate commercial developments from residential development and transit.
  8. Locate buildings near street corners to improve access to bus stop and provide pedestrian connections to neighboring activities.
  9. Establish appropriate lot patterns that provide direct and visible connection of sidewalks between blocks.
  10. Provide direct connection between cul-de-sacs.
  11. Ensure appropriate width of sidewalks and street crossings to facilitate continuous movement of two people comfortably walking side by side with space for one to pass.
  12. Provide clear and direct pedestrian entries from the street, not just from parking areas.
  13. Minimize and remove physical obstructions/barriers that impede direct pedestrian access. Provide access through walls, fences, and other obstructing features and elements.
- B. **Continuity.** Link schools, neighborhoods, parks, activity centers, and other destinations with a continuous pedestrian network.
1. Provide a continuous and understandable pedestrian network by incorporating the following facilities, features, and elements:
    - a. Continuous sidewalks on both sides of the street,
    - b. A continuous alignment of building facades near the sidewalk,
    - c. A consistent park strip between the curb and the sidewalk, and
    - d. Consistent street trees.
  2. Use pedestrian-scaled furnishings, signs, landscaping, and facilities that appear as unified and themed entities in pedestrian networks, areas, and corridors.
  3. Ensure that sidewalk cafes and other uses/features of the sidewalk area support rather than obstruct a continuous pedestrian network.
  4. Provide bridges and crossings over drainages, and other features that are major barriers to a continuous pedestrian network. Design these crossings to minimize out-of-direction travel.
- C. **Street Crossings.** Develop safe, comfortable, and attractive street crossings.
1. Develop median refuges to improve the safety and comfort of arterial street crossings.
    - a. Establish standardized street-crossing improvements that include crosswalks, lighting, median refuges, corner sidewalk widening, sign, signals, and landscaping.
    - b. Develop and design crosswalks that:
      - i. Are well-marked and visible to vehicles,
      - ii. Fit and enhance the local urban design context and character, and
      - iii. Provide for safety for all age/ability groups.
  2. Develop civic improvements, including pedestrian-scale elements, landscaping, and sidewalk widenings, which improve the visibility and suggestion of pedestrians at street crossings.
  3. Develop street-calming improvements to enhance the safety of street crossings.
  4. Ensure that signals, signs, and street markings have clear vehicular and pedestrian indications for street crossings.
  5. Ensure that street crossings are lit to reflect the patterns of use.
  6. Provide automatic pedestrian signal phases at high-demand intersections and pedestrian buttons at low-demand areas.
  7. Provide for an exclusive pedestrian signal phase to improve safety.
  8. Consider installing stop bars on all approach legs at signalized intersections.

9. Minimize curb radius to:
    - a. Reduce the speed of right-turning vehicles.
    - b. Reduce the distance for the pedestrian to cross the street.
  10. Locate lighting, signal and signage poles so they do not conflict with safe pedestrian circulation.
  11. Allow access for people of different abilities.
- D. **Visual Interest and Amenity.** Develop comfortable and attractive pedestrian facilities and settings to make an interesting pedestrian network.
1. *Pedestrian Facilities and Elements:*
    - a. Provide pedestrian-scale improvements that fit the urban context of the area.
    - b. The color, materials, and form of pedestrian facilities and features should be appropriate to the area where they are located, as well as to the functional unity of the pedestrian network.
    - c. Develop attractive improvements including landscaping, vertical treatments, sidewalk widening, and furnishings which improve the character and pedestrian scale of the urban environment.
    - d. Incorporate special design features, public art, and site details that can enhance the pedestrian scale of streets and become an urban amenity.
    - e. Develop standardized lighting improvements which enhance the character of the pedestrian environment. Consider the following criteria:
      - i. Varied light spacing and heights to be compatible with site-specific issues.
      - ii. Poles to incorporate pedestrian-scale features such as banners, potted plants, etc.
      - iii. Attractive luminaries to provide an organized and unified appearance throughout the pedestrian network.
    - f. Use quality materials and design, which will minimize maintenance needs.
    - g. Maintain pedestrian facilities.
    - h. To enhance the character of the pedestrian environment and to encourage pedestrian activities along the sidewalks on key streets and corners, prohibit large surface parking lots in these locations.
  2. *Landscaping:*
    - a. Develop a continuous edge of deciduous canopy street trees on both sides of the street. Select species that provide shade, shelter, scale and continuity for the pedestrian/ sidewalk environment.
    - b. Develop attractive landscaping by considering the following criteria:
      - i. Reduce clutter of little plants and disorganized planting.
      - ii. Establish patterns/spacing of street trees to provide formal visual rhythm, a linear edge to, and organization of the sidewalk area.
      - iii. Use trees of similar height and structure to provide a unified image and cohesive character for feature corridors and districts.
      - iv. Use specialty-landscaping themes to help distinguish districts.
      - v. Use landscaping selectively to soften the harsh appearance of some buildings and parking lots at the sidewalk edge.
    - c. Construct retaining walls of materials which reduce their apparent scale, like brick or stone, or treated architecturally to create an appropriate scale and rhythm. Hanging or climbing vegetation can soften the appearance of retaining walls. High retaining walls should be terraced down and include landscaped setbacks.
    - d. Design attractive urban open spaces to have a distinctive and definite shape, enclosed by buildings on 2-3 sides so the area feels like an "outdoor room," which is favored by pedestrians. These spaces must be located in the right places to be useful. Locate at intersections of 2 or more pedestrian routes.
    - e. Screen blank building walls and retaining walls with landscaping, architectural features, or art to enrich the pedestrian environment.

3. *Buildings:*

- a. Encourage outdoor cafes and activity areas that provide pedestrian character and human scale to the sidewalk environment.
- b. Construct windows and other openings that will relieve blank walls, adding visual interest, improving pedestrians' sense of security, and introduce a human scale to building frontages.
- c. Provide human scale character to the street with appropriate building design and details.
- d. Incorporate building entry details like porches and recesses, occupied spaces like bay windows and balconies.

E. **Security:**

1. Develop secure pedestrian settings by developing a well-lit inhabited pedestrian network and by mitigating the impacts of vehicles.
2. Streets should appear inhabited to the greatest extent possible. New development should accommodate human activity by providing balconies, terraces, and yards for residents' use and interaction. In mixed-use buildings, retail elements like large windows, canopies, and integrated signage add activity by enhancing the shopping experience. Entrances, porches, balconies, decks, and seating should be located to promote pedestrian use of the street edge by providing weather protection, security, and safety.
3. Provide clear and direct lines of sight in pedestrian settings to increase feelings of security. Achieve this by minimizing use of shrubs, walls, berms, and other vertical features, which screen lines of sight to pedestrian facilities.
4. Provide general illumination for security and visual safety of pedestrian areas and corridors.
5. Use lighting fixtures to identify and highlight key pedestrian facilities and elements such as pedestrian intersections, paths, sidewalks, and entrances, while enhancing safety, and security. Provide a desirable and safe pedestrian environment by decreasing glare associated with tall, high intensity street fixtures. Provide indirect light to the sidewalk by lighting elements in the street environment such as trees, walkways, canopies, and entryways. All lighting should be down-directed and should not contribute to light pollution whenever possible.
- f. Develop physical buffers/edges between sidewalks and streets/parking lots.
- g. Avoid over-illumination of pedestrian areas, since these create, by contrast, shadowy areas nearby which may be threatening to pedestrians.

**E-7 PEDESTRIAN CROSSINGS AT HIGH-USE PEDESTRIAN AREAS**

The greater the number of lanes that a pedestrian must cross, the greater is the pedestrian's exposure to vehicles. In addition, wider streets tend to carry higher volumes of traffic and higher speeds. Intersections crossing multiple lanes require pedestrian enhancements. If it is determined that the traffic demand warrants additional through or turn lanes, then pedestrian mobility should be evaluated to determine whether additional pedestrian enhancements should be required to offset the traffic impacts on the pedestrian. The following are key intersection street-crossing design elements that should be considered in the guidelines for designing intersections.

- A. **Number of Lanes:** The number of travel lanes to cross is a significant safety factor for a pedestrian crossing the street. When the number of travel lanes increases, it is generally in response to higher traffic volumes. In addition, the pedestrian is exposed for a longer period of time in crossing those additional lanes.
- B. **Lane Widths:** Typically a travel lane is 12 feet. If the lane width is reduced, the time it takes a pedestrian to cross is also reduced. In addition, the narrower travel lane tends to calm or slow traffic, which is of benefit to the pedestrian.
- C. **Parking Lanes:** When parking lanes along a street exist, the pedestrian walk-time to cross the street increases as the pedestrian must first cross the parking lane before beginning to cross the traffic lanes. At intersections, vehicles that make wider, higher-speed turns often use these parking lanes.

- D. **Travel Speed:** Speed is a significant safety factor for a pedestrian trying to cross a street. Factors that might affect speed include minimum cross-street traffic, low number of access points, and geometric design. As mentioned previously, lane widths also contribute to travel speed.
- E. **Crosswalks:** Enhancements to crosswalks, including color, stenciling, and pavement treatment should be considered for all major intersection entryways to mixed-use centers.
- F. **Signal Indication:** Pedestrian signal heads should be included for all signalized intersections with crosswalks. The heads should be easily visible to the pedestrian.
- G. **Lighting Levels:** The intersection should be well lit so the pedestrian is visible at night.
- H. **Pedestrian Signal Indication and Pedestrian Buttons:** It would be optimal for all activity areas to have automatic pedestrian signal phases. Pedestrian push-buttons should be required for all other intersections. The location of the push-button should be easily accessed and not require pedestrians to divert from their travel route. Signals without dedicated walk phases or push-buttons are not acceptable since the only way a pedestrian may ever get a green light is when an automobile on the side street activates the cycle.
- I. **Countdown Signal Heads:** At signal locations that experience a high number of pedestrians, such as at transit stops or universities, where there have historically been a large number of pedestrian accidents, or any other area where pedestrians often cross during the “Do Not Walk” phase, countdown signal heads should be considered to provide additional information about how much time is remaining for being able to cross the street.
- J. **Median Refuge Areas:** Painted medians offer little refuge other than getting out of a lane of traffic. Substantive raised medians of significant width with a cut-through provide some increase in security for the crossing pedestrian. For arterials with four or more lanes, a raised median refuge island should be designed for all intersections and mid-block crossings.
- K. **Amenity:** In pedestrian districts, amenities should include such elements as signing and design features that strongly suggest the presence of a pedestrian crossing.
- L. **Line-of-sight Distance:** Sight distance measures the unobstructed view between the motorist and the pedestrian. This can be a problem particularly when a motorist intends to make a left turn under the permissive left-turn phase, and it is difficult to see pedestrians around the opposing left-turn vehicle. Sight distance should be analyzed as a part of all intersection designs.
- M. **Right Turn on Red (Left Turn on Red on One-Way Streets):** One of the greatest increases in pedestrian accidents has been associated with right turns on red lights. Research has determined that an extremely high number of drivers do not stop at the crosswalk before making their turn and, instead, continue on while looking to the left for approaching conflicting vehicles, not to the right for pedestrians in the crosswalk. Some jurisdictions have installed signs that do not permit right turns on red in specific places and circumstances. As part of the traffic study, locations that would experience high pedestrian volumes should be identified. Restricting right turns on red should be at the discretion of the City Engineer.

## E-8 MID-BLOCK CROSSINGS

- A. Mid-block crossings should be provided where there is an existing or potential pedestrian demand to cross at higher volume roadways or streets where crossings are greater than 800 feet. Ideally, these crossings should be accommodated with a refuge island. Center crossing islands allow the pedestrian to deal with only one direction of traffic at a time and enable them to stop partway across the street and wait for an adequate gap in traffic before crossing the second half of the street.

- B. Where mid-block crosswalks are installed at uncontrolled locations (i.e., where no traffic signals or stop signs exist), crossing islands should be considered as a supplement to the crosswalk in order for the pedestrian to only cross one direction of traffic at a time. Providing an angled pedestrian travel way across the median allows oncoming traffic to be better viewed before crossing, further improving safety.

## E-9 CROSSWALK LOCATIONS AND WARRANTS

- A. From a pedestrian-network perspective, extended distances between intersecting streets make it difficult for the pedestrian to cross the facility. Ideally, a system of grid streets that are around 400 feet in separation would be optimal. This distance would be appropriate for local streets within residential neighborhoods and activity centers. Spacing between intersections on primary arterials and secondary arterials might need to be longer to accommodate the higher volumes of traffic, storage for signals, and signal progression.
- B. The location and frequency of crosswalks along primary arterials, secondary arterials, and collector streets need to be balanced between need, traffic flow, and cost. Whereas an optimum pedestrian environment would have crosswalks at all major activity areas and spaced at 400-foot increments, too great a frequency of crosswalks can create a situation where the typical driver becomes immune to the crosswalk, which might create a safety hazard. The following should be considered when considering locations for crosswalks:
1. All signalized intersections,
  2. Locations that will attract high pedestrian volumes,
  3. Locations for safety, such as crosswalks to school sites, transit stops or activity areas, and
  4. Mid-block crossings at a minimum of 350 feet from adjacent intersection crosswalks.
- C. In areas that have high volumes of pedestrians crossing a street, pedestrian crosswalks should be installed. The need for these crosswalks is a function of roadway type and pedestrian volumes. Roadway types from collector to primary arterial result in more travel lanes in which the pedestrian is exposed as he/she crosses, higher traffic volumes, and often increased traffic speeds. Figure E-8 is a guideline as to where unprotected intersection and mid-block crosswalks should be considered based on street width/type and pedestrian volumes.

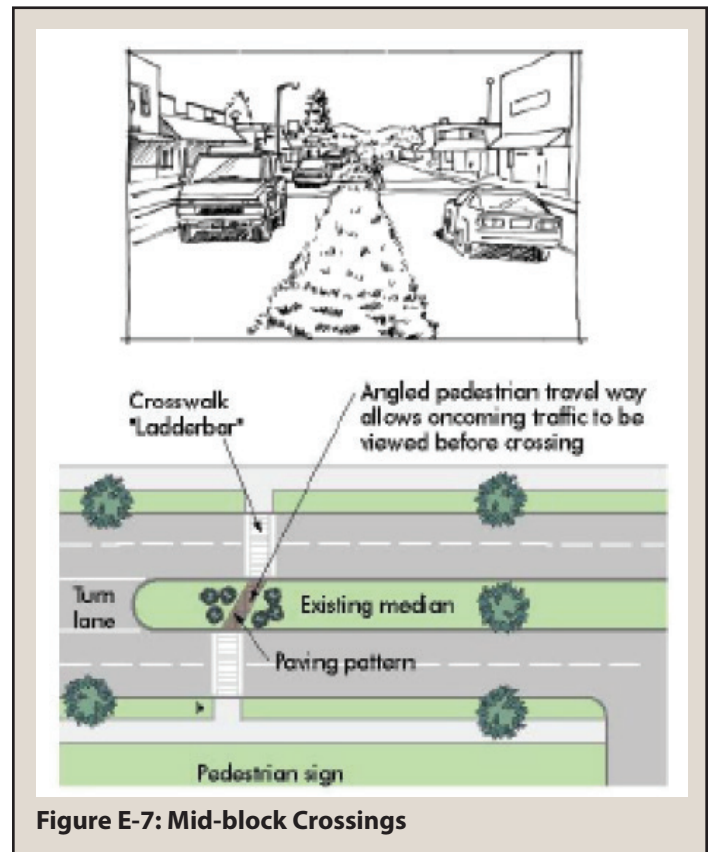

**Figure E-7: Mid-block Crossings**

## E-10 ELEVATED CROSSWALK TO REFUGE ISLAND

In locations where a dedicated right-turn lane is needed as determined by the Traffic Impact Study, the design should consider a raised crosswalk at the height of the curb and a ramp for the vehicles to cross the crosswalk. This resulting design is similar to that of a 10-foot speed table with a six-inch up-ramp, table, and down-ramp.



## E-11 BULBOUTS/CURB EXTENSIONS

In special applications, the City or developer may consider bulbouts to reduce traffic speed and improve pedestrian safety. Bulbouts are simply intersection curb extensions, which extend past the parking lanes, but not into the bicycle or through lanes. The advantages of bulbouts are as follows:

- A. Bulbouts provide an entry or gateway statement into activity areas or where high volumes of pedestrians are present. As a motorist enters an area where a bulbout is present, the extension provides a clear difference between the arterial function and a local pedestrian activity area.
- B. Bulbouts enhance the visibility of the pedestrian because they physically permit the pedestrian to be located closer to the travel lanes, especially where parking is permitted, and allow the pedestrian to be seen more easily by the driver.
- C. Bulbouts constrict traffic flow through reduced lateral clearance. This reduction effects a reduction in travel speed along the corridors and improves safety for both pedestrians and vehicles.
- D. The bulbout changes the turning radius at the intersection, which reduces turning speed and vehicle and pedestrian conflicts.
- E. The extension of the bulbout reduces the time it takes pedestrians to cross from curb to curb. This reduction in pedestrian crossing time consequently reduces the time the pedestrian is exposed to moving vehicles.
- F. Bulbouts change the character of the intersection from automobile-dominant to pedestrian-friendly and multi-modal shared.
- G. Bulbouts can be an extremely positive visual and aesthetic enhancement. Features such as pedestrian lighting, planters, and benches create a focal point for pedestrian activity and change the character of the intersection from automobile to pedestrian. It should be noted that care must be taken when aesthetically enhancing bulbouts as such enhancements can block sight distances and create accident problems.

## E-12 MODERN ROUNDABOUTS

- A. The use of modern roundabouts as an alternative to conventional stop- and signal-control intersections is becoming increasingly popular in the United States. Studies conducted by the insurance industry have determined that these types of intersections result not only in a significant decrease in automobile traffic at an

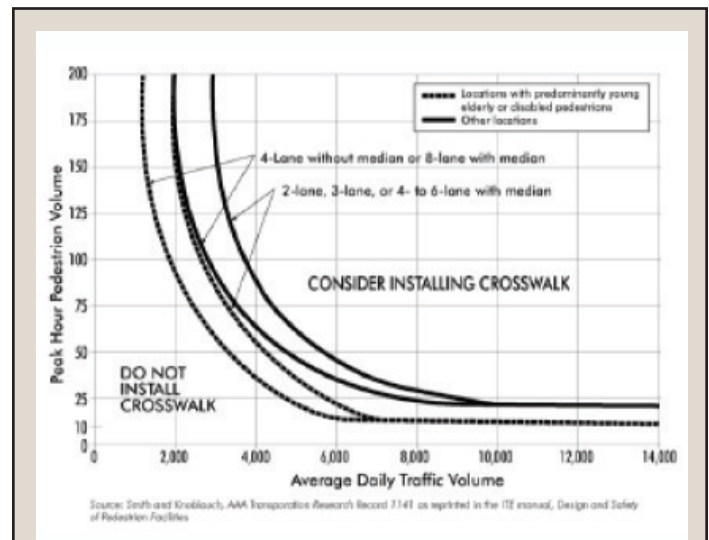

**Figure E-8: Guidelines for the Installation of Marked Crosswalks at Uncontrolled Intersections and Mid-block Crossings**

Source: Smith and Knoblauch, AAA, Transportation Research Record 1141 as reprinted in the ITE Manual, Design and Safety of Pedestrian Facilities

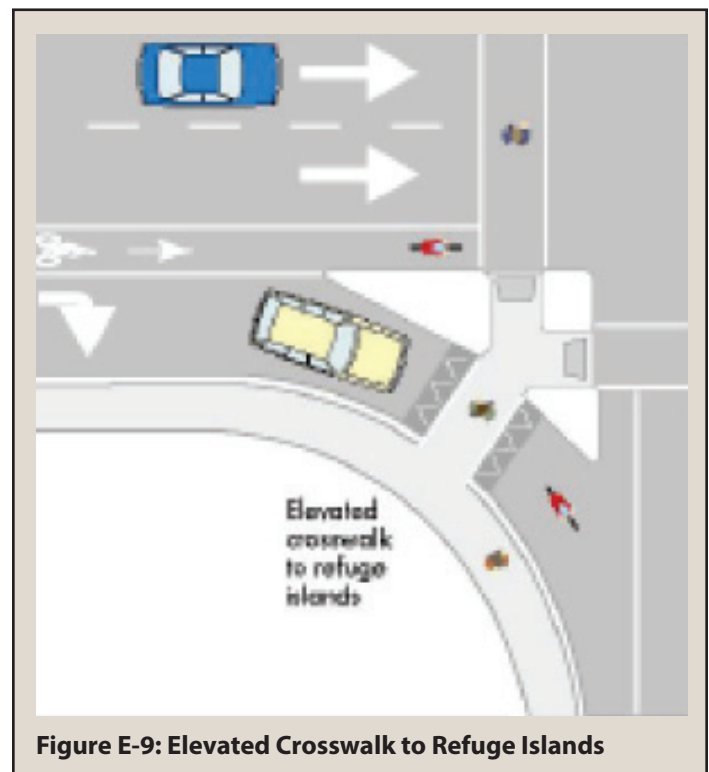

**Figure E-9: Elevated Crosswalk to Refuge Islands**

intersection, but also in a reduction in pedestrian accidents as well.

- B. At a conventional intersection, the pedestrian faces four potential vehicle conflicts:
  1. Crossing movements on red (typically high-speed, illegal)
  2. Right turns on green (legal)
  3. Left turns on green (legal for protected-permitted or permitted left turn phasing)
  4. Right turns on red (typically legal)
  
- C. Pedestrians at roundabouts, on the other hand, face two conflicting movements on each approach:
  1. Conflict with entering vehicle
  2. Conflict with exiting vehicle
  
- D. The crossing of the roundabout is relatively simple. The pedestrian waits for a gap in traffic and crosses from the curb to the splitter island that provides protection, and then crosses from the splitter island to the far curb when a gap in traffic occurs. Crossing in two steps reduces the vehicle exposure in half for each segment. In addition, safety is improved because the vehicles are forced to go slower through the roundabout than at a conventional intersection. The modern roundabout pedestrian crosswalk treatment consists of:
  1. ADA compliant ramps
  2. Conventional crosswalk striping
  3. Raised splitter island pedestrian pass-through and refuge
  4. Pedestrian crossing sign
  5. Yield street markings
  6. Yield signs
  
- E. Typically, the crosswalk is placed approximately one car length from the yield bar to permit the pedestrian to safely walk behind a vehicle that is awaiting a merge into the roundabout when traffic permits.

### E-13 DESIGN, LOCATION AND TYPE OF BICYCLE PARKING FACILITIES

Convenient and secure bicycle parking is necessary at the destination end of a path or route. Inadequate bicycle parking facilities and fear of theft are major deterrents to bicycle transportation. A sufficient supply of effective bicycle parking requires a properly designed rack in an appropriate location for the type of use.

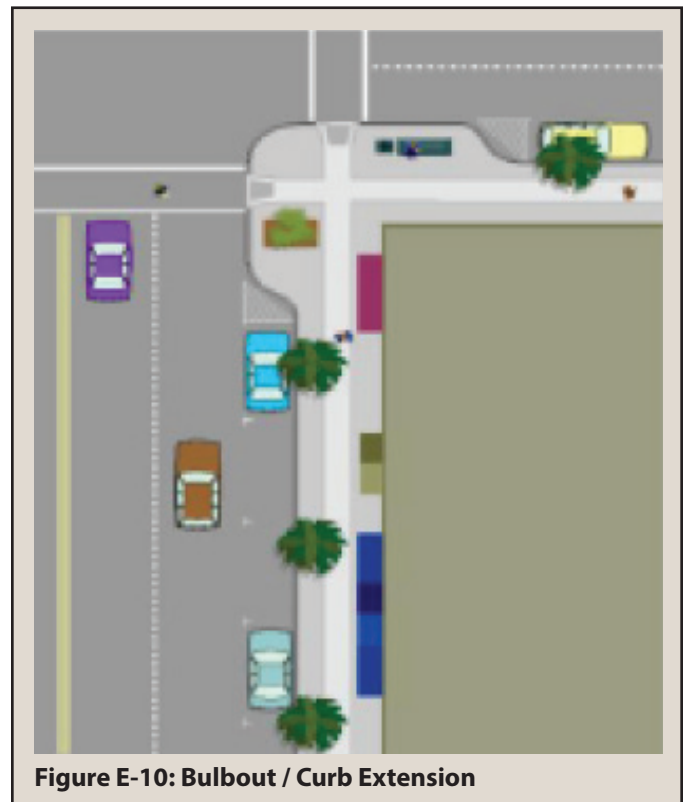

**Figure E-10: Bulbout / Curb Extension**

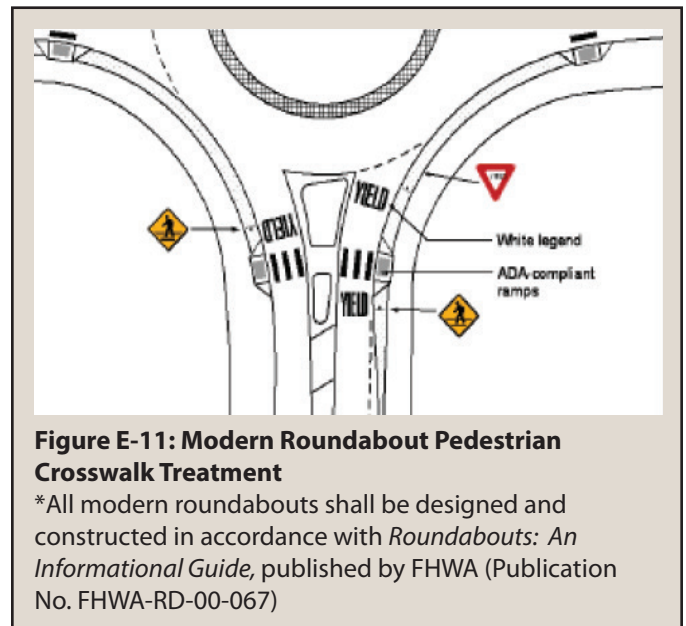

**Figure E-11: Modern Roundabout Pedestrian Crosswalk Treatment**

\*All modern roundabouts shall be designed and constructed in accordance with *Roundabouts: An Informational Guide*, published by FHWA (Publication No. FHWA-RD-00-067)

- A. **Design Standards.** Bicycle facilities shall be designed in accordance with Chapter 2 of the *AASHTO Guide* for development of bicycle facilities. Traffic control shall be in accordance with the *Manual on Uniform Traffic Control Devices*. Bicycle parking may be provided in floor-, wall- or ceiling-mounted racks. Racks at each location should:
1. Hold the bicycle frame, not just a wheel.
  2. Allow use of a U-shaped shackle lock.
  3. Accommodate a wide range of bicycle sizes, wheel sizes and types.
  4. Be covered with material that will not chip the paint of a parked bicycle with which it comes in contact.
  5. Not have hazards, such as sharp edges.
- To ensure bicycle parking will be used, the bicycle parking should be easy to find, convenient, and secure enough to reasonably safeguard against bicycle theft. Facilities can be located where cycles are already parked.
- B. **Type and Location.** There are many types of bicycle racks and lockers available. Some are suitable for certain situations but not others, and some designs are unsuitable anywhere. There are two general categories of bicycle parking requirements:
1. *Long-Term (Class I)* parking is needed where bicycles will be left for hours at a time. It requires a high degree of security and weather protection, with well-designed racks in covered areas, lockers, storage rooms, or fenced areas with restricted access.
  2. *Short-Term (Class II)* parking is needed where bicycles will be left for short stops. It requires a high degree of convenience (as close to destinations as possible). At least some short-term bicycle parking should be protected from the weather (a portion can be unprotected, since demand tends to increase during fair weather).
- C. **Visibility.** Racks should be highly visible so cyclists can spot them immediately when they arrive from the street. A visible location also discourages theft and vandalism.
- D. **Security.** Adequate lighting and surveillance is essential for the security of the bicycles and the users. Bicycle racks and lockers must be well anchored to the ground to avoid vandalism and theft.
- E. **Weather Protection.** A portion of bicycle parking should be protected from the weather (some short-term bicycle parking can be unprotected since bicycle use tends to increase significantly during fair weather, as mentioned previously). This can use an existing overhang or covered walkway, a special covering, weatherproof outdoor bicycle lockers, or an indoor storage area.
- F. **Clearance.** Adequate clearance is required around racks to give cyclists room to maneuver and to prevent conflicts with pedestrians or parked cars. Racks should not block access to building entrances or fire hydrants.

**APPENDIX F – GUIDELINES FOR PREPARING A JOINT PARKING STUDY**

In association with Section 6.2.5 of this code, planning applications where collective or shared parking is contemplated may be required to include parking accumulation studies for existing facilities similar to the proposed uses and for the surrounding uses with which joint parking is being considered. The applicant shall adhere to the following guidelines:

- A. Prepare a scaled drawing indicating the parking areas and the facilities requiring parking in the area.
- B. Determine if shared parking is possible by examining the land-use mix adjacent to the subject site, the size of each use, the type of operation, and, most importantly, the 12- to 24-hour parking demand characteristics of each use.
- C. Conduct the 12- to 24-hour parking accumulation studies for existing facilities similar to those for which reciprocal parking is being requested, and for the surrounding ones with which shared parking is anticipated. Weekly and monthly variations in parking demand must be taken into consideration.
- D. Occupancy factors may be a consideration in determining how well the parking spaces for the existing adjacent uses, with which shared parking is being contemplated, are currently being utilized. These can be determined during the accumulation studies outlined above.
- E. Based on the data for existing similar facilities, the total parking demand for all uses included in the shared parking analysis must be projected for each hour over a 12- to 24-hour period for the most critical day of the week and month of the year. This must include the Thanksgiving-to-Christmas period, if the facilities are affected by this period. This will determine the minimum number of spaces that must be provided.
- F. Based on this analysis, if the maximum number of vehicles accumulated during a 24-hour period for all uses exceeds the number of spaces that were required by this code for all the uses, no reciprocal or shared parking will be permitted.
- G. If the projected peak accumulated demand is lower than the spaces required, elimination of those spaces exceeding the maximum accumulated demand may be considered by permitting shared parking, providing details of an agreement are provided guaranteeing perpetuity of such shared parking arrangements in case of future ownership or tenant changes.

## APPENDIX G STREETScape DESIGN, PLANNING AND MAINTENANCE GUIDELINES

G-1	Intent
G-2	Applicability
G-3	Medians
G-4	Tree Lawns
G-5	Planting Guidelines
G-6	Planting Standards
G-7	Irrigation Standards
G-8	Turf Seeding Standards
G-9	Fine Grading and Soil Preparation Standards
G-10	Streetscape Maintenance Standards

**G-1 INTENT**

Streets are the most significant portion of the public realm of most communities – both in area and in investment. The intent of the Streetscape Design Guidelines is to ensure that the quality of the streetscape environment, including medians and tree lawns within the public right-of-way, is attractive, functional and links the public street corridors together through a unified City-wide plan.

**G-2 APPLICABILITY**

The Streetscape Design Guidelines are used in the evaluation of new development and redevelopment projects. The guidelines set forth acceptable standards and practices to meet development requirements and design objectives in this code. These guidelines apply to projects located within the public right-of-way along arterials, collectors, and local streets. For additional information on related streetscape design, see the City of Cheyenne's current editions of the *Landscape Design Regulations (UDC Section 6.3)*, *City Urban Forestry Ordinance*, and *Street Design Types (UDC Section 4.3)*.

**G-3 MEDIANS**

- A. **Landscape Plan.** All street designs that include a median shall submit a median landscape plan that meets or exceeds the standards of this section.
- B. **Timing of Median Landscaping.** Landscaping of medians shall occur in connection with the adjoining development or with improvement of the roadway as described below.
  1. *Arterial Streets.* Landscape development shall occur with the improvement of the roadway.
  2. *Non-arterial Streets.* Landscape development shall occur in connection with the adjoining development.
- C. **Median Planting Design Options.** Landscaping shall be based on one of the following styles:
  1. *Tree Corridor Style.* Deciduous trees shall be planted in an evenly spaced row. Ornamental trees may be planted in an evenly spaced row at the end of the median where the landscape area narrows. Trees should have variety. Yet, strong contrasts within tree rows should be avoided with repetition or subtle changes in form, size, texture, and color.
    - a. Tree plantings shall be made in the center of the landscape area at regular spacing of 25 feet minimum to 40 feet maximum. Shade or ornamental tree plantings shall not occur where the distance between median curbs is less than 7 feet.
    - b. Shrubs or groundcover plantings shall be made to provide a homogeneous surface with minimal amount of variation. Plant material shall have a mature height of 18 inches or less. Plantings may be excluded from the ends of

- medians for maintenance or visibility concerns.
  - c. Organic mulch shall be placed at a depth of 3 inches directly on top of the soil surface in all landscape areas. Fabric shall be placed on top soil under mulch as a weed barrier.
  - d. Landscape area within the median shall be graded level 3 inches below the edge. Berming or cresting the landscape area is not permitted.
  - e. Flowering annual or perennial plants shall be restricted to high visibility areas and may occasionally be used as a landscape element in a section of the street corridor in wider sections of medians. Separate irrigation zones shall be installed for annual beds.
  - f. The tree corridor style is appropriate for medians in any classification of street where the median is at least 7 feet in width.
2. *Variety Combination Style.* Trees and shrubs of several types and forms should be planted. Continuity is not provided by the perpetual repetition of individual elements but by the occasional repetition of a dominant tree form. This continuity may be achieved by planting groups of the same evergreen tree as a repeated form along the street corridor. Plant groups placed between the repetitive dominant tree forms may be in sharp contrast to each other—in terms of size, color, form, and texture—to emphasize visual variety and detail. Tree selection may be from shade, evergreen or ornamental types. The landscape area of a median must be 12 feet in width if evergreen trees are to be planted. Deciduous trees must be at least 3.5 feet, and evergreen trees 6 feet from the edge of the landscape area. Spacing between trees may vary within the following requirements:

TABLE G-1: SIZE AND SPACING OF TREES		
	<i>Canopy Shade Tree</i>	<i>Ornamental</i>
Minimum Size	2.0" Caliper (1.25" Residential Street)	1.5" Caliper
Minimum Spacing	25 feet	20 feet
Maximum Spacing	40feet	30 Feet

- D. **Arterial Median Protection.** The border of a landscape median in an arterial street shall be raised with a vertical wall or shall include an inclined splash block of a medium-to-dark earthtone color (see Median Planting detail below).
- E. **Hardscape.** Landscape paving shall be used as a median cover wherever a landscape area is not provided. The hardscape may completely cover a median, or part of a median, that is less than 7 feet in width. Landscape paving may be integrated into a tree corridor or variety combination style, but shall not exceed 40% of the area of such a landscaped median. Landscape paving shall be of an aggregate or paver type and of a medium-to-dark earth-tone color.

**G-4 TREE LAWN**

- A. **Landscape Plan.** All developments or roadway improvements shall submit a tree lawn landscape plan that meets or exceeds the standards of this Section.
- B. **Tree Lawn Planting Design Options**
  - 1. Canopy shade trees shall be planted at 25 to 40 foot intervals (spacing) in the center of all such tree lawn

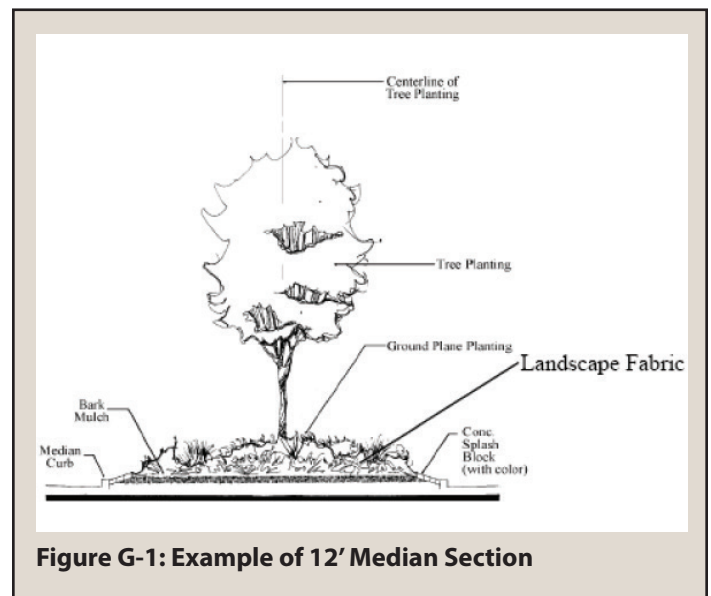

Figure G-1: Example of 12' Median Section

areas whenever the sidewalk is separated from the street by a tree lawn. Whenever the sidewalk is attached to the street, the canopy tree shall be established 2.5 feet behind the sidewalk at 25- to 40-foot spacing, or in tree wells were specified by the Street Standards.

2. Ornamental trees shall be planted in substitution of the canopy shade trees where overhead lines and fixtures prevent normal growth and maturity.
3. The tree lawn ground plane planting design shall consist of turf grass and automatic irrigation system unless otherwise specified in these regulations. Xeriscape design principles should be incorporated whenever appropriate. Within the tree lawn, the ground plane should be attractive but not dominant, uniform, uncluttered, and low in height and growth.
4. Trees must be planted in the center of the tree lawn measured from the front of the sidewalk and back of the curb.
5. No street tree shall be planted closer to the street than 2.5 feet from the back of the curb for ornamental trees and 3.5 feet from the back of curb for large shade trees.
6. Larger maturing trees should be placed 40 feet apart and smaller maturing trees (such as in the Variety/Combination Median style) may be placed 20 feet apart. When space is limited or to achieve certain design effect, closer spacings may be considered.
7. No tree shall be planted closer than 10 feet from any driveway or alley, nor shall a tree be planted in such a manner that its eventual growth cannot be reasonably controlled so as to avoid interference with or obstruction to any improvements installed for public benefit.

C. **Utilities.** Landscape and utility plans shall be coordinated. The following list sets forth minimum dimension requirements for the most common tree/utility separations. Exception to these requirements may occur where utilities are not located in their standard designated locations, as approved by the City. Tree/utility separations shall not be used as a means of avoiding the planting of required street trees.

1. 40 feet between street trees and streetlights. 15 feet between ornamental trees and streetlights. (See figure below.)
2. 10 feet between trees and water or sewer lines.
3. 4 feet between trees and gas lines.
4. 10 feet between trees and fire hydrants
5. Street trees on local streets planted within the 8-foot-wide utility easement may conflict with utilities and should be avoided. Additional conduit may be required to protect underground electric lines.

D. **Visual Clearance or Sight Distance Triangle.** A visual sight distance triangle, free of any structures or landscape elements greater than 2.5 feet in height shall be maintained at street intersections and driveways, and comply with Section 4.3.5 of these Standards.

1. Fences shall not exceed 42 inches in height and shall be of an open design. Fences shall not be permitted in the clear sight triangle described in Section 4.3.5.
2. Deciduous trees may be permitted to encroach into the clearance triangle provided that the lowest branch of any such tree shall be at least 12 feet from grade at maturity.
3. At the intersection of roadways or vehicular access points, no plant material with a mature height greater than 2.5 feet shall be planted within a sight triangle measuring 35 feet along the boundary of each of the intersecting roadways, measured from the point of intersecting curblines, except where engineering standards indicate otherwise.
4. Trees shall be located no closer than 10' to any driveway or alley.

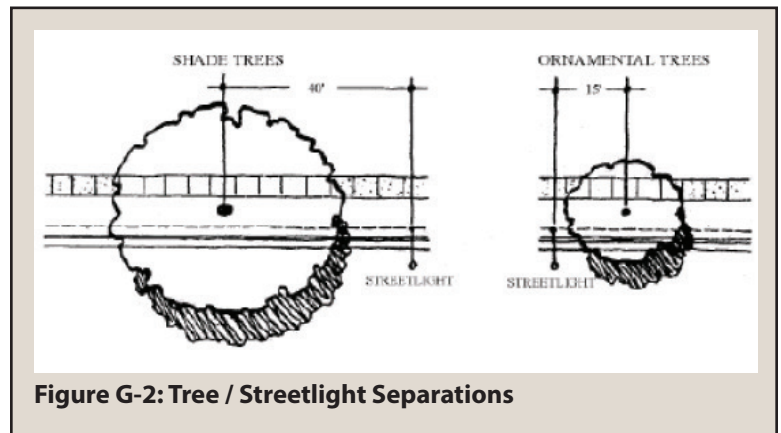

Figure G-2: Tree / Streetlight Separations

**G-5 PLANTING GUIDELINES**

- A. **Weather, Climate, Soils.** Due to severe climate conditions in Cheyenne, consideration of long-term maintenance is an important element of the initial design of any streetscape. Precipitation is limited to 15 inches per year on average, with extreme temperatures in the 90's in the summer and as low as -20 in the winter. As much as one-third of the rain comes in May and June as heavy downpours. Heavy snows in spring and fall may break tree limbs, coming when trees are in leaf. Mild spring and fall weather is broken by sudden frosts.
- B. **General Planting Considerations.** Severe conditions require careful design and selection of vegetation. Suitable plant lists are available at the Botanical Gardens and Urban Forestry websites. Adaptable plants that have proven hardy are recommended wherever possible. Xeriscape methods are advisable, such as grouping plants with similar water demands together and watering higher-demand plants on a different sprinkler schedule while drought-tolerant plants may be watered by rain or bubbler irrigation. Soil preparation is a critical step in all xeriscape. General planting considerations include the following:
1. Coordinated tree planting sets a rhythm and pattern for the street. By alternating tree types, a sense of enclosure can be achieved while slower growing trees are established.
  2. Gardens of perennials and annuals should be restricted to high-priority areas for maintenance and safety reasons.
  3. Consider utilizing xeriscape principles for high-traffic, low-maintenance, or otherwise dry or difficult areas.
- C. **Streetscape Approval.** The developer shall contact the City Project Manager, Project Engineer, or Construction Manager before work on any City maintained streetscape commences.

**G-6 PLANTING STANDARDS**

- A. **Projects Governed by Planting Standards.**
1. Public projects such as streets, medians, and tree lawns shall provide for tree planting as a part of the development process. The landscape plan for such projects shall be approved by the City Forestry Department and must adhere to the design objectives, spacing locations, and other requirements with the City.
  2. Private projects shall provide for street tree planting as part of the development process. Street trees shall be located on the public right-of-way and must adhere to the design objectives, spacing, location, and other requirements of the City. These plantings are meant to work as a cohesive standard with the City's current Landscape ordinance. Exceptions can be made for tree plantings in the right-of-way due to utility placement and other variations that would be deemed by the City Engineer to make street trees in the right-of-way unfeasible.
- B. **Specific Standards.**
1. Existing healthy street trees shall be preserved wherever possible. If a tree is removed, mitigation trees of at least equal value as that of the removed tree shall be provided as determined by the City Forester.
  2. New street trees that are part of a new development project and infill plantings shall be at least 1.5 to 2-inch caliper.
  3. Automatic irrigation shall be provided to all trees, shrubs, and turf unless otherwise specified in these regulations.
- C. **Size, Type, and Distribution of Tree Species.**
1. Public tree planting can be accomplished with container trees, balled and burlapped trees or use of a tree spade. Bare-root plantings are not permitted without written permission as determined by the City Forester.
  2. No single species shall make up more than 50% of the total City tree population. The following requirements are for tree species at any one site:



<b>TABLE G-2: TREE STATISTICS</b>	
<b>Number of Trees at Site</b>	<b>Maximum % of any 1 Species at Site</b>
10 to 19	50
20 to 39	33
40 to 59	25
60 or more	15

3. The plant palette listed in the 'Adopted Species List' available at the City Forestry Department constitutes the official tree species for Cheyenne. Species other than those included in this list shall not be planted as street trees without written permission of the City Forester.

**D. Soil Preparation Requirements.**

1. All utilities shall be located prior to trenching and shall be protected from damage.
2. Trenching around established trees is prohibited within 10' of trunk.

**G-7 IRRIGATION STANDARDS**

- A. Irrigation systems in any public ROW (which are now or will at some future point be maintained by the City of Cheyenne) must be constructed in accordance with the standards set forth in the current edition of the City of Cheyenne, Parks and Recreation *Standards and Specifications*.
- B. Commercial properties would be advised to utilize commercial-grade irrigation equipment.
- C. The City Engineer reserves the right to require adherence to Irrigation Standards set forth in the City of Cheyenne, Parks and Recreation *Standards and Specifications* on ROW or properties that may have extenuating or special circumstances.
- D. If an irrigation system is dedicated to the City then all components including irrigation meter pits and backflow preventers shall be placed in the public right-of-way or an easement dedicated to the City.

**G-8 TURF SEEDING STANDARDS**

**A. General.**

1. *Seed Mix*. Shall be approved by the Project Manager, Project Engineer, or Construction Manager based on the activity to take place, planned irrigation method and maintenance to be performed in the area being seeded.
  - a. Pre-approved Dryland Mix (for temporary or permanent unmowed and non-irrigated areas):
    - (1) 44% Fairway Crested Wheatgrass
    - (2) 10% Blue Grama
    - (3) 10% Butte Side Oats Grama
    - (4) 3% Texoka Buffalograss
    - (5) 20% Annual Rye Grass
    - (6) 10% Western Wheat Grass
    - (7) 3% Critana Wheat Grass
  - b. Pre-approved Irrigated Seed Mix (for mowed applications) *Fescue Mix*:
    - (1) 10% Chewing Fescue
    - (2) 10% Creeping Fescue

## APPENDIX G

- (3) 10% Hard Fescue
- (4) 10% Sheep Fescue
- (5) 20% Tall Fescue (Regiment II)
- (6) 20% Tall Fescue (Crew Cut II)
- (7) 20% Tall Fescue (Blade Runner)

2. *Seeded Areas.* Seeding is allowed in Tree Lawns where approved by the City, on side slopes of detention ponds to be maintained by the City, and in some temporary dryland applications. No seeding is allowed in medians. All proposed seeded areas are to be specifically approved by the City and shall be of the latest crop.

B. **Submittals.** The developer shall submit certificates showing State, Federal or other inspection showing source and origin of materials to the City.

C. **Materials.**

1. *Seed.* Shall be of fresh, clean, new crop seed composed of the varieties approved by the City with tested minimum percentages of purity and germination clearly labeled on the package. All seed shall be free of *Poa annua* and all noxious objectionable weeds with a maximum crop of .1% and maximum weeds of .1% weeds.
2. *Mulch.*
  - a. For slopes 30% and less: Native grass straw without weed seed and consisting of grasses as specified for seeded application.
  - b. For slopes 30% and greater, and inaccessible areas: Hydromulch using Weyerhaeuser "Silva-Fiber" mulch or approved equal. The wood cellulose fiber for hydraulic mulching shall not contain any substance or factor which might inhibit germination or growth of grass seed. It shall be dyed a green color to allow metering of its application.
  - c. Tackafier use Teratack III, or approved equal.
3. *Netting.* For slopes greater than 30%, use Soil Saver jute netting, or approved equal. Netting to be stapled with No. 11 gauge steel wire forged into a 6-inch long U-shape and painted for visibility in mowed areas. Netting must be placed so it does not cause a problem for mowers.
4. *Fertilizer.* Use a fertilizer with a formula of 18-46-0 on all areas to be seeded.
5. *Inspection.* Inspect finish grade and trim where needed to obtain finish grades of 1 inch below adjacent pavements. Verify positive drainage away from all structures. Verify or complete removal of rock and debris larger than 1 inch from all areas to be seeded.

D. **Execution.**

1. *Fertilizer.* Apply 8 pounds per 1,000 square foot of seeded area and rake lightly into top 1/8 (0.12) inch of soil just prior to seeding operation.
2. *Seeding.*
  - a. Do not sow seed in windy weather or when ground is frozen or otherwise untillable.
  - b. Use Brillion type drill or hydraulic seeding methods. Drill seed in manner such that after surface is raked and rolled, seed has ¼ (0.25) inch of cover.
  - c. Hydraulic seeding will be used in areas that are not accessible for machine methods. A hydraulic pump capable of being operated at 100 gallons per minute and at 100 pounds per square inch pressure should be used. The equipment shall have an acceptable pressure gauge and a nozzle adaptable to hydraulic seeding requirements. Storage tanks shall have a means of agitation and a means of estimating the volume used or remaining in the tank. Do not seed and mulch in the same operation.
  - d. Rates: Dryland Mix—30 pounds pure live seed per acre. Irrigated Mix—10 pounds per 1000 sq. ft.
3. *Mulching.*
  - a. Native Grass Mulch: Apply at a rate of 2 tons per acre. Mulch seed beds within 24 hours after seeding.
  - b. Hydromulching: Wood cellulose fibers must become evenly dispersed when agitated in water. When sprayed

uniformly on the soil surface, the fibers shall form a blotter like ground cover which readily absorbs water and allows infiltration to the underlying soil. Cellulose fiber mulch shall be added with the proportionate quantities of water and other approved materials in the slurry tank. All ingredients shall be mixed to form homogenous slurry. Using the color of the mulch as a metering agent, spray-apply the slurry mixture uniformly over the seeded area. Apply with tackafier used at a rate of 120 pounds per acre. Unless otherwise ordered for specific areas, fiber mulch shall be applied at the rate of 2,000 pounds per acre. Hydraulic mulching shall not be performed in the presence of free surface water resulting from rains, melting snow or other causes.

4. *Netting.* Net areas over 30% slope. If contractor fails to net and subsequent soil erosion occurs, contractor shall re-establish finish grade, soil preparation, seed bed and apply netting at no cost to the City of Cheyenne.
  5. *Watering.* Immediately after seeding and mulching, water seeded area slightly, but with care so that no erosion takes place and no gullies are formed. Water a minimum of three times a day and keep seeded area moist until turf is established. Sloped areas should be hand watered until turf is established to prevent erosion; water these areas more often but for shorter periods of time.
  6. *Clean Up.* Remove all hydromulch and other mulch materials from all plant materials, fences, concrete and other areas except for seed bed.
  7. *Protection.* Provide and install barriers as required to protect seeded areas from pedestrian and vehicular damage. Provide signage if needed.
- E. **Guarantee/Warranty.** Warrant seeded areas for consistency and completion of coverage. Re-seed as needed to ensure a successful stand of grass that is acceptable to the City. Once a vigorously growing stand of grass is achieved with a minimal amount of weeds, the request for Construction Acceptance may be made.

## G-9 FINE GRADING AND SOIL PREPARATION STANDARDS

### A. **General.**

1. Soils tests conducted by a certified or qualified soils testing lab must be completed and submitted to the City for review; recommendations in the lab reports shall be followed in all cases. Generally this will include soil amendment and fertilizer recommendations; in some cases, all new topsoil will be required.
2. If the site is undisturbed, topsoil is to be stripped to a 6-inch depth, or to topsoil depth as determined by field inspection. Stockpile and re-spread stripped topsoil over landscape areas after rough grades are established. If site has been disturbed, or sufficient topsoil is not available, topsoil is to be imported to achieve 6-inch depth in all landscaped areas.

### B. **Submittals.**

1. *Soil Amendment.* Submit sample and written confirmation from supplier of material composition including: percent organic matter, salts, nutrient composition and trademark. Sample is to be representative.
2. *Topsoil.* Submit sample and written confirmation from supplier of material composition including: percent organic matter, salts, and nutrient composition. Sample is to be representative.

### C. **Materials.**

1. *Soil Amendment.* Certified organic material or approved equal. A high quality composted material containing a minimum of 50% organic matter. The mixture shall be free from clay subsoil, stones, lumps, plants or roots, sticks, weed stolons, seeds, high salt content and other materials harmful to plant life. The compost shall be coarsely ground with an even composition and have an acidity in the range of pH 5.5 to pH 7.0. All material shall be sufficiently composted such that no material used is recognizable.
2. *Topsoil.* Must be taken from a well drained, arable site and shall be reasonably free of subsoil, stones, clods, sticks, roots and other objectionable extraneous matter or debris. No stones or other materials over 2 inches in size shall be allowed. Topsoil shall contain no toxic materials and have an acidity in the range of pH 5.5 to pH 8.5.
3. *Fertilizer.* Balanced fertilizer with a chemical analysis of 10-25-12.

**D. Inspection.**

1. Locate all utilities prior to trenching and protect from damage.
2. Accept rough grading from other contractors per approved plans. Rough grade inspection is to allow for 6-inch minimum depth of topsoil and specified soil amendments as part of the fine grading work.

**E. Execution.**

1. Protect existing trees, landscaping, existing structures, fences, sidewalks, utilities, paving, curbs, and other features remaining as final work during construction. Contact the City Forester for proper procedures on how to implement tree protection.
2. Grub and remove unsuitable woody and rock material present in the surface grade.
3. Take precautions to accommodate proper drainage and flow during and after grading and soil preparation.
4. Apply herbicide to areas where noxious weed beds have been established and/or where seed mix is to be planted. Herbicide must be applied by certified contractors at the rate recommended by the manufacturer after proper notification has been done in accordance with chemical applicator's standards. Precautions must be taken to avoid drifting of spray onto other properties; spraying shall not be done in breezy conditions. Harm to plant material not designated for herbicide application shall be replaced by the contractor.
5. Rip to 6-inch depth with agriculture subsoiler in all areas to receive plantings. Contact City Forester regarding acceptable procedures to not disturb existing roots or established trees. Remove all objects greater than 2 inches in diameter.

**F. Application.**

1. Spread 6 inches topsoil over entire landscaped area, except in the dripline of existing trees, and grade to smooth and even lines. Establish swales and drainage as required per plans.
2. Evenly distribute soil amendment at rate of 3 cubic yards per 1,000 square feet of area, or 1-inch depth over the entire area to be prepared; alter rate if soils test recommends otherwise. Till amendments into top 6 inches of soil. Compact to a firm, but not hard density (80% of Standard Proctor Density at 2% optimum moisture). Evenly distribute triple superphosphate fertilizer at the rate of 15 pounds per 1,000 square feet; modify type and rate if soils test recommends otherwise.
3. Trim finish grade elevations adjacent to paved areas to 1 inch below pavement finish grade.

**G-10 STREETScape MAINTENANCE STANDARDS**

- A. **Purpose.** The purpose of this section is to ensure a consistent, high-quality appearance for all streetscapes, whether maintained by the City, its agents, or by private developers, businesses, or individuals. Given the high visibility of City streetscapes, the public is able to observe maintenance practices in the field as well as the results of that maintenance. The public perception of a well maintained landscape is promoted by practices which benefit the health of the landscape materials and achieve a neat, well-cared-for appearance. Quality maintenance is a function of workmanship, funding, and technique. These standards will ensure that all streetscapes are cared for in a manner which reflects the high esteem that citizens have for these important public spaces. Generally, all landscaping shall be maintained in a healthy condition throughout the growing season. A neat and attractive appearance is essential. Irrigation systems, structures, and sidewalks shall be maintained to represent the original integrity of the design and installation.
- B. **Planting and Maintenance Standards.** The practices of the City of Cheyenne Forestry Department will serve as the standard for planting and maintenance for all trees in the public rights-of-way; Forestry Department standard practices apply whether the work is performed for the City contractually, by the City, or by private entities or individuals.
- C. **Permit.** As per city code, a permit must be obtained from the City Forestry Division before any planting, pruning, removal, or destruction of any tree, shrub, or hedge in or upon the public right-of-way. All work requiring a permit shall be conducted in a manner as to cause the least possible interference with or annoyance to others. Pedestrian and vehicular traffic shall be

allowed to pass through the work areas only under conditions of safety and with as little inconvenience and delay as possible.

- D. **Maintenance.** Maintenance of ground-level streetscapes shall be the responsibility of the adjacent property owner.
1. Mowing shall not interfere with the use of streets and sidewalks and shall meet the provisions of the City nuisance and weed ordinance.
  2. Turf should be maintained within the designated planting area, and mulch, either wood or rock, should be free of weeds.
  3. Dead plants should be replaced, clippings and trash removed, and mulch and plants replaced as they diminish and die off.
  4. Landscaped area should be kept as similar to its initial appearance as possible.
  5. Irrigation times and installations should occur per City requirements.

#### **G-11 ESTABLISHMENT MAINTENANCE FOR NEWLY PLANTED TREES.**

- A. **New Residences.** Information regarding street tree planting and maintenance requirements can be obtained from the City Forester's office.
- B. **Establishment Maintenance Guidelines.**
1. Maintain irrigation standards. Newly planted trees require additional irrigation for 2 to 3 years. Particularly during the first year this can exceed water demand of turf. New trees should receive 1 inch of irrigation per week during the first growing season, applied over the root system. Normal turf irrigation is generally adequate (1 inch per week) for the second and third year. 15 inches of supplemental irrigation per growing season is adequate after establishment. Irrigation times should occur per City requirements.
  2. Insure irrigation rates for new trees in turf areas are adequate during establishment even when that is greater than water demand for turf.
  3. Mulch newly planted trees over the root system with 3 inches of organic mulch. Trees in turf zones shall be planted in 4-foot diameter rings.
  4. Inspect new plantings on a regular basis and remove dead, broken and diseased branches.
  5. Remove sprout growth from stems and root collars early in the growing season.
  6. Evaluate mulch on an annual basis. Re-mulch trees to maintain a maximum of 3-inch deep mulch cover. Keep mulch 3 inches away from the tree trunk.
  7. Maintain tree rings in turf zones as weed free.
  8. Monitor insect and disease levels and control measures implemented when necessary following Integrated Pest Management (IPM) practices.
  9. Remove all nursery or other tags from plants and landscape materials.
  10. Remove tree wrap and stakes the next spring season after planting.

NOTE: See "Adopted Species List" available at the City Forestry Department and online at <http://www.cheyennetrees.com/>

**APPENDIX H [RESERVED]**

**APPENDIX I [RESERVED]**

**APPENDIX J [RESERVED]**



## APPENDIX K – AMENDMENTS

The following is a log of amendments to this code including text and zoning map amendments. A copy of the official ordinance authorizing the amendments is on file with the City.

DATE	ORD. NO.	TEXT AMENDMENT OR ZONE CHANGE	AMENDED SECTIONS OR NEW ZONING DISTRICT
6/11/2012	3949	Zone Change	Diamond Estates 3rd, MUB to MR-2
7/9/2012	3953	Zone Change	Saddle Ridge 4th, HR-2 to MR-2
7/9/2012	3954	Zone Change	TCI Tire, CB to LI
8/13/2012	3956	Zone Change	Meridian Bank & Trust, MUR to MUB
10/8/2012	3959	Zone Change	Chaplin Park, MR-1 to MUB
10/8/2012	3960	Zone Change	Family Dollar, MUB to CB
10/8/2012	3961	Zone Change	Taco Johns, MUB to CB
12/20/2012	3963	Zone Change	City Parking Lot, MR-1 to MUB
1/14/2013	3964	Zone Change	2100 Pioneer, P to CBD
2/11/2013	3968	Zone Change	Johnson, CB to MUB
2/11/2013	3969	Zone Change	Diamond Estates 4th, HR-2 to MR-2
3/11/2013	3970	Zone Change	Storey Blvd Extension, P to NB
4/8/2013	3971	Zone Change	Plains Industrial, A-2 to HI
5/13/2013	3972	Zone Change	21 Max, MR-1 to NR-3
5/13/2013	3973	Zone Change	2114 Pioneer, P to CBD
7/8/2013	3985	Zone Change	Hutchins, CB to HI
7/8/2013	3986	Zone Change	Cooley, CB to MUB
7/22/2013	3987	Zone Change	Green House Data, HI to CB
7/22/2013	3988	2013 Annual Review Amendment 1 - "High Priority Quick Fixes"	Table 1-1, Summary of Review Authority (Variances); Figure 4-18, Corner Sight Distance; Section 4.3.6.c, Access Width; Table 4-13, Lot Access Width (Note 2 deleted); Table 4-17, Minimum Pavement Sections (numeric changes); Table 5-1, Zoning District Uses (Apartments in NR-2 & NR-3); Sections 5.1.5a and b (certain rear setbacks changed from 25' to 20'); E-8 (source added).
8/12/2013	3989	Zone Change	Swan Ranch II Annexation, LI & PUD (County) to LI & PUD (City)
8/12/2013	3990	Zone Change	Kornegay, MR-2 to CB
8/12/2013	3993	Zone Change	Polk, AG to LI
9/9/2013	3996	Zone Change	Cheyenne Housing Authority, MUB to P
9/9/2013	3997	Zone Change	Terre Pont, A-1 & MU (County) to CB
10/14/2013	4000	Animal Care/Clinics/Kennels	Table 5-1, Zoning District Uses (Animal Care - Hospital/Clinic Conditional in NB & MUB, Animal Care/Kennel Permitted in LI)
10/28/2013	4001	Annexations	Repealing & re-enacting Sec. 2.4.2 to refer to Wyoming Statutes only.
1/13/2014	4014	Zone Change	Lots 15 & 16, Block 17, Crest Ridge, 4th (Pronghorn Apartments)
2/10/2014	4017	Election Signs	Add subsections 15 & 16 to 6.5.5.b, Exemptions
2/10/2014	4018	Zone Change	Lot 8, Block 223, Original City, LI to MUR
2/24/2014	4020	Administrative Adjustments	Amending Sec. 2.3.4.b.3 to increase the amount of allowable administrative adjustment from 10 percent to 50 percent

## APPENDIX K – AMENDMENTS, CONTINUED

The following is a log of amendments to this code including text and zoning map amendments. A copy of the official ordinance authorizing the amendments is on file with the City.

DATE	ORD. NO.	TEXT AMENDMENT OR ZONE CHANGE	AMENDED SECTIONS OR NEW ZONING DISTRICT
2/24/2014	4021	Urban Lofts	Adding Urban Loft Building to Sec. 1.4.4.a, Residential Uses, Table 5-1, Zoning District Uses, and other applicable sections of Articles 5 and 6
3/10/2014	4022	Zone Change	South 79 feet of Lot 8, Block 311, Original City, CB to MUR
3/10/2014	4023	Zone Change	Lot 1, Block 1, Public Works Addition, CB to LI
5/12/2014	4024	Front Setback Alternative Compliance	6.6.3.d: Alternative Compliance. Detached Dwelling Lot Types and Semi-Attached Dwelling Lot Types may propose a principal building front setback of 15' when the standards in <i>Compact and Mixed-Density Neighborhood Design</i> (6.6.4) and access width standards in Table 4-13 are met. In existing neighborhoods the front setback shall not be less than the context of adjacent detached or semi-attached structures.
6/23/2014	4028	Animal Clinics in CBD	Table 5-1, Zoning District Uses (Animal Care - Hospital/Clinic Conditional in CBD)
7/28/2014	4032	Zone Change	Del-Van Storage, MU (County), MUB, & MR-1 to MUE (City)
7/28/2014	4034	Landscaping Irrigation	Adding 6.3.7.f.4, to allow an exception to irrigation requirements for seeded drought tolerant grass ground covers in LI & HI zones (Sections G-4.B.3 and G-6.B.3 as well)
8/11/2014	4036	Zone Change	US 30 Business Plaza, AR (County) to CB (City)
8/25/2014	4039	Landscaping Point Values	Amending Tables 6-8, 6-9, 6-11, and 6-12
9/8/2014	4040	Zone Change	Diamond Estates, 5th Filing, MR (County) to MR-2 (City)
10/13/2014	4043	Zone Change	Original City, Block 509, Lot 7 & 8, MR-1 to MUB
12/8/2014	4047	Zone Change	Plains Industrial Park, 3rd Filing, AG (County) to HI
1/12/2015	4052	Zone Change	Carter Cottages, HR (County) to HR-2
1/12/2015	4054	Zone Change	Thomas Heights, A-1 (County) to AR / A-1 (County) and AR to MR-2
1/12/2015	4051	Zone Change	Schrader Funeral Home, MUB to MUR
2/23/2015	4056	Zone Change	The Bluffs, 10th Filing, LR (County) and LR-2 to MR-2
2/23/2015	4057	Zone Change	Triumph Addition, 2nd Filing, CB to MUB
3/9/2015	4059	Zone Change	Chukker Ridge, 2nd Filing, A-2 (County) to MR-2
3/9/2015	4061	Zone Change	Koduri Properties, MR (County) to MUB
3/9/2015	4063	Zone Change	Torres Property at Land Court, MR (County) to MR-1 (City)
6/3/2015	4069	Notification Boundary	Qualifying area for notification mailings for Sections 2.1.4, 2.2.1, 2.2.2, 2.2.4, & 2.3.2.
6/8/2015	4076	Zone Change	Waterford Square Annexation, LI (County) to NR-3 & CB (City)
6/8/2015	4075	Zone Change	300 East 16th Street - Verizon Wireless, CB to MUB
8/15/2015	4082	Zone Change	Cheyenne Business Parkway, 8th Filing, HI to AG
8/15/2015	4083	Zone Change	Cheyenne Business Parkway, 9th Filing, HI to LI and HI to AG
8/15/2015	4084	Text Amendment	Billboards zoning district clarification
9/2/2015	4085	Text Amendment	Conditional Use Approval Applicability
9/2/2015	4086	Text Amendment	Removal of Sunset Clause on Administrative Adjustments

**APPENDIX K – AMENDMENTS, CONTINUED**

The following is a log of amendments to this code including text and zoning map amendments. A copy of the official ordinance authorizing the amendments is on file with the City.

<b>DATE</b>	<b>ORD. NO.</b>	<b>TEXT AMENDMENT OR ZONE CHANGE</b>	<b>AMENDED SECTIONS OR NEW ZONING DISTRICT</b>
9/2/2015	4087	Text Amendment	Drainage Impact Studies rewrite, updating Defined Terms, and repealing Appendix H
9/21/2015	4091	Zone Change	Holdrege’s Addition, 4th Filing, MR-1 to MUB
9/21/2015	4092	Zone Change	L1, B1 Lowe Subdivision and L1&2, B1, Good Addition, NB to CB
9/21/2015	4093	Zone Change	Heiduck Addition, LI (County) to LI (City)
9/21/2015	4094	Zone Change	Saddle Ridge, 7th Filing, CB to MR-2
9/21/2015	4096	Zone Change	Saddle Ridge, 8th Filing, A-1 (County) to MR-2 (City)
9/21/2015	4098	Zone Change	Coulson Addition, MR (County) to MR-2 (City)
10/16/2015	4100	Zone Change	RKRR Addition, MR-2 to MUB
12/23/2015	4106	Zone Change	522 Van Lennen Avenue, P to MUB
12/23/2015	4107	Zone Change	1605 E 23rd Street, CB & MR-1 to MUB
12/23/2015	4108	Zone Change	4015 N College Drive, Dry Creek Business Park, MR-2 to CB
1/5/2016	4109	Text Amendment	Increasing Maximum Total Lot Coverage Allowed in Some Residential Lot Types
1/5/2016	4110	Text Amendment	Accessory Dwelling Units
1/16/2016	4112	Zone Change	1315 E 21st Street, MR-1 to MUB
1/16/2016	4115	Zone Change	Summit Park, A-1 (County) to NR-3 (City)
2/12/2016	4119	Zone Change	Campstool Addition, 3rd Filing, LI to HI
4/18/2016	4123	Zone Change	Block 349, Original City, LI to MUB
4/18/2016	4124	Zone Change	Block 396, Original City, CB to MUB
5/14/2016	4128	Zone Change	Braden Homesites, AR (County) to MUB
6/22/2016	4135	Zone Change	E 27th St and Evans Ave., Block 76, Original City, MR-1 to NR-3
7/1/2016	4137	Zone Change	Portion of Lot 9, Block 2, Parsons Addition, MR (County) to MR-2
7/18/2016	4148	Zone Change	Lummis/Read, LI (County), A-2 (County), and PUD (County) to P and AG
7/18/2016	4149	Zone Change	South Park Estates, 9th Filing, MR-1 and MR-2 to NR-3
8/13/2016	4152	Zone Change	USI Plaza, MR-1 to NR-2
10/14/2016	4156	Zone Change	Habitat 13th Street, CB to MR-2
10/14/2016	4158	Zone Change	Southwest Industrial Park, LI (County) to LI (City)
11/18/2016	4160	Zone Change	2514 Dell Range Blvd, MUB to CB
1/14/2017	4163	Zone Change	Dell Range Retail Center, MUB to CB
2/18/2017	4164	Text Amendment	UDC Section 2.1.5 Lot Line Adjustment Plat Waiver
2/18/2017	4166	Zone Change	Tract 71 and portions of Tracts 70 & 72, Allison Tracts, 2nd Filing from MR (County) to MR-2
3/21/2017	4169	Text Amendment	Consolidating LR-1 and LR-2 into LR, MR-1 and MR-2 into MR, and HR-1 and HR-2 into HR
4/14/2017	4172	Zone Change	Tyrell Addition, 2nd Filing, Lot 1, Block 1 and Lot 1, Block 2, CB to LI
5/12/2017	4174	Zone Change	Grand Mesa, NR-2 to NR-3
5/12/2017	4176	Zone Change	Th Bluffs, 11th Filing, LR (County) to MR (City)
6/19/2017	4181	Text Amendment	Clarifying Special Use Approval
7/14/2017	4188	Zone Change	1920 Dillon Ave, LI to MUR

## APPENDIX K – AMENDMENTS, CONTINUED

The following is a log of amendments to this code including text and zoning map amendments. A copy of the official ordinance authorizing the amendments is on file with the City.

DATE	ORD. No.	TEXT AMENDMENT OR ZONE CHANGE	AMENDED SECTIONS OR NEW ZONING DISTRICT
7/14/2017	4187	Zone Change	North College Subdivision, MR to NR-3 and P
8/19/2017	4192	Zone Change	Lincoln Valley Tracts, a portion of Tract 1, AR (County) to AR (City)
8/19/2017	4193	Zone Change	South Park 10th Filing, CB to LI
8/19/2017	4194	Zone Change	Converse Place Apartments, NB to NR-3
9/2/2017	4197	Zone Change	Sunnyside Addition, MU (County) to MUB (City)
9/16/2017	4202	Zone Change	Mission Village, MR (County) to MR (City)
9/16/2017	4199	Text Amendment	Allowing Utility Stations in AG, AR, and AD Zones
9/16/2017	4200	Text Amendment	Allowing Home Occupations Within the NB, CB, CBD, LI, and HI zones.
9/29/2017	4203	Text Amendment	Defining Through Lot and Clarifying Setbacks For Accessory Buildings on Through Lots
10/13/2017	4204	Zone Change	Interior Heights, 2nd Filing, A-1 (County) to AR (City)
11/18/2017	4207	Zone Change	107 W 8th Avenue, MR to CB
11/18/2017	4208	Zone Change	409 W 4th Street, HR to CB
11/18/2017	4210	Zone Change	Swan Ranch Rail Park, 11th Filing, Swan Ranch Rail Park PUD to LI
1/12/2018	4214	Text Amendment	Creating Impoundment Yards as a land use category and allowing the use in the LI, HI, and MUE zones as a use by right, and in the MUB and CBD zones as a Conditional Use
2/22/2018	4217	Zone Change	Whitney Ranch, 1st Filing, from A-1 (County) to MR and MUB
2/22/2018	4220	Text Amendment	Clarifying Group Dwelling, Nursing Home, and Assisted Living use definitions and permissions
5/19/2018	4224	Zone Change	Lot 14, Block 5, Replat Homestead Addition, First Filing, MR (County) to NR-2
5/19/2018	4226	Zone Change	Saddle Ridge, 13th Filing, A-1 (County) to MR and P
5/19/2018	4227	Zone Change	510 W. 29th Street, Conditional MUR to NB
7/14/2018	4238	Zone Change	Lots 1-2, Block 1, Simpson Estates, MUB to CB
7/14/2018	4239	Zone Change	North Gate Village, MR to MUB
9/29/2018	4244	Zone Change	6110 Brimmer Road, LR (County) to LR (City)
9/29/2018	4245	Text Amendment	Allowing the SD1 Semi-Attached Dwelling / Large Lot lot type in the MR zone
9/26/2018	4249	Zone Change	Portion of the W1/2 W1/2 Section 17, T14N, R66W, of the 6th Principal Meridian, County A-1 and Rural Residential to MUR
12/10/2018	4250	Zone Change	Lots 9-12, Block 9, Meadowbrooke Park Subdivision, HR to CB
12/10/2018	4251	Zone Change	Lot 1, Block 1, Plaza Del Range, 2nd Filing Subdivision, CB to HR
1/22/2019	4256	Zone Change	Lot 1-2, Block 534, Original City, MR to NR-2
1/22/2019	4257	Zone Change	A parcel of land consisting of Tract B, Overland Trails 5th Filing Subdivision, Overland Trails PUD to LI
1/22/2019	4258	Text Amendment	Allowing Director to approve parking above the maximum, based on parking study
3/11/2019	4262	Zone Change	Lot 4, Block 2, Swan Ranch Rail Park Third Filing, County Swan Ranch PUD to City Swan Ranch PUD (Ord. 3989)
3/11/2019	4263	Zone Change	Hutchins Corner 2nd Filing: Lots 4 and 5, CB to LI
4/16/2019	4265	Zone Change	Lots 1, 2, 5, 6, 7, and 8, Block 1, and Lots 2, 3, and 4, Block 2, Countryside Addition: County AR to CB

## APPENDIX K – AMENDMENTS, CONTINUED

The following is a log of amendments to this code including text and zoning map amendments. A copy of the official ordinance authorizing the amendments is on file with the City.

DATE	ORD. No.	TEXT AMENDMENT OR ZONE CHANGE	AMENDED SECTIONS OR NEW ZONING DISTRICT
6/4/2019	4271	Zone Change	FW Subdivison: County CB to CB
7/17/2019	4278	Text Amendment	To allow smaller wireless communication faciiliites and generally update the Wireless Communi-cation Faciliites section of the Unified Development Code
8/17/2019	4280	Text Amendment	Electronic Message Center Allowances
8/17/2019	4283	Text Amendment	Entertainment Uses
1/30/2020	4293	Zone Change	N1/2 of Lot 4, Williams Subdivision: County LR to LR
4/13/2020	4301	Zone Change	Tract of Land Generally Located West of Westland Road at Crow Creek: County LI to P
4/13/2020	4302	Zone Change	Lots 5-8, Block 271, Original City, Cheyenne: LI to MUB
4/13/2020	4303	Text Amendment	To reduce the required frontage of Lot Type DD7 from 48-feet to 40-feet and from 60-feet to 45-feet on corner lots.
6/8/2020	4309	Text Amendment	To define and Clarify the purpose of remainder lots.
6/8/2020	4310	Text Amendment	To modify time limits associated with temporary uses.
6/8/2020	4311	Text Amendment	To modify posted notice requirements for site plans and administrative approvals, clarify pro-cedures for modification of site plans, modify authority to initiate text amendments. and modify criteria for variance approval.
7/13/2020	4317	Zone Change	Lots 8-11, Block 42, Mountview Park, 6th Filing: LR to MUR
7/13/2020	4318	Zone Change	Lots 6-8, except that fractional part of said Lot 8 belonging to and a part of the R/W of the Colo-rado And Southern Railway Company, Block 225, Original City, Cheyenne: LI to MUB
7/27/2020	4319	Zone Change	A poetion of the SE1/4 of Section 33, T.14N., R.66W., 6th P.M: CB to MUB
8/10/2020	4321	Zone Change	Lots 1 and 2 and a portion of a 20 foot vacated alley being adjacent to and west of said Lots I and 2, Block 1, Prairie Hills Addition: County MU to MUB
10/12/2020	4326	Text Amendment	To create the support services zone district and establishing design criteria.
11/9/2020	4329	Zone Change	Lot 3, Block 4, Country Club Estates Second Filing: HR to CB
11/9/2020	4330	Zone Change	Lot 1, Block 2 and Lot 1, Block 3, Back 40 Subdivision, Second Filing: MUB to CB
11/9/2020	4332	Text Amendment	To define, establish permissibility, and create specific use standards for the use “Emergency Shelter”.
1/11/2021	4338	Zone Change	A Portion of the North Half of the Southwest Quarter of the Northwest Quarter (N½SW¼NW¼) of Section 20, Township 14 North, Range 66 West of the 6th P.M.: County A-1 Agricultural and Rural Residential to P
1/11/2021	4339	Text Amendment	To define, establish permissibility, and create specific use standards for the use “Mini Storage”.
2/8/2021	4342	Zone Change	Lot 1, Block 2, Bison Business Park: County A-1 to HI and Lot 1, Block 1, Bison Business Park: County A-1 to AG
2/8/2021	4343	Zone Change	Lot 1, Block 1, South Cheyenne, Second Filing: LI to MR
2/8/2021	4344	Zone Chnage	Lots 7 and 7 1/2, Block 4, Lake Minnehaha Resubdivision and a portion of a 16 foot vacated alley adjacent to and north of said lots: MR to CB
3/8/2021	4345	Text Amendment	Amending Section 5.8.4, Fences.
3/8/2021	4346	Text Amendment	Amending the definition of Dwelling Unit and creating the definition for Family Unit.
4/12/2021	4352	Zone Change	Lots 9, 10, 11, and 12, Block 1, Holmes Corner: CB to MUB
4/12/2021	4353	Text Amendment	Amending Section 6.6.3.b.1, Encroachments

**APPENDIX K – AMENDMENTS, CONTINUED**

The following is a log of amendments to this code including text and zoning map amendments. A copy of the official ordinance authorizing the amendments is on file with the City.

DATE	ORD. No.	TEXT AMENDMENT OR ZONE CHANGE	AMENDED SECTIONS OR NEW ZONING DISTRICT
4/12/2021	4355	Zone Change	Land located north of Dell Range Blvd and West of Whitney Road: County A-2 to MR
4/12/2021	4357	Zone Change	Property Generally Located North of Dell Range Blvd and East of Griffith Avenue: County MR to MR
5/10/2021	4359	Zone Change	Northwest of and adjacent to the intersection of Dell Range Blvd and Whitney Road: County A-2 to AG
5/24/2021	4363	Text Amendment	Amending Section 5.1.5.d Lot Type MD1 and MD2 to allow a maximum of 80% lot coverage and 5.6.1.d Lot Types P-CV1, P-VC2 and P-VC3 to allow a maximum of 80% lot coverage.
6/14/2021	4371	Text Amendment	Amending Section 1.3.7 Fees
6/14/2021	4373	Zone Change	Land located north of Pershing Blvd and West of Christensen Road: County A-1 to MR
6/14/2021	4375	Zone Change	Lot 1, Block 2, Lot 1, Block 3, and Lot 2, Block 4, Bison Business Park, 2nd Filing: County A-2 to AG; Lots 1 and 2, Block 1, Bison Business Park, 2nd Filing: County A-2 to LI; Lot 1, Block 4, Bison Business Park, 2nd Filing: County A-2 to HI
6/28/2021	4382	Text Amendment	To create the Urban Use Overlay district and establishing design criteria.
7/26/2021	4388	Zone Change	Lot 1, Block 1, Meadowlark Estates, 2nd Filing: County MU to CB; Lots 2-7, Block 1 and all of Block 2, Meadowlark Estates, 2nd Filing: County LR to LR; All of Block 3, Meadowlark Estates, 2nd Filing: County LR to MR
7/26/2021	4391	Zone Change	Lot 1 and 2, Block 1, Equipoise Addition: MR to NR-2
7/26/2021	4392	Text Amendment	To create Public Safety Fees.
9/13/2021	4394	Zone Change	Lots 7-18, Block 3, Miller Addition: MR to NR-2
9/27/2021	4395	Text Amendment	To clarify and better facilitate Cottage Lot development.
10/11/2021	4397	Zone Change	Lots 1-23, Block 1; all of Block 2; all of Block 3; all of Block 4; all of Block 5; all of Block 6; and Lots 1-17 and 19, Block 7, Whitney Ranch 4th Filing: AG to MR; Lot 1, Block 8, Whitney Ranch 4th Filing: AG to HR; Lots 24 and 25, Block 1; and Lot 18, Block 7, Whitney Ranch 4th Filing: AG to MUB; Lot 2, Block 8, Whitney Ranch 4th Filing: AG to CB
10/25/2021	4398	Text Amendment	Clarification to the interpretation of Lots and amend accessory building regulations.
10/25/2021	4399	Text Amendment	Modifying the density standards of UDC 5.1.5.d “Multi-dwelling Buildings (Apartment)” Lot Types
11/8/2021	4403	Zone Change	Tract 1, Park Estates, 4th Filing: County LR to MR
11/22/2021	4404	Text Amendment	Modifying Articles 2.1 and 2.2 regarding posted and published notice requirements for divisions of land and zoning applications
12/13/2021	4407	Zone Change	Land located Northeast of the intersection of Old Happy Jack Road and Westland Road: County LI to LI
12/13/2021	4408	Zone Change	Lot 13, Block 5, Westgate Addition (except the north 2.47’ to State Highway: HR to CB
1/10/2022	4409	Text Amendment	Creating the definitions, ‘Functional Turf’ and ‘Non-functional Turf’ and amending various sections of Article 6
2/14/2022	4415	Zone Change	South 1/2 of Lot 5, Block 486, Original City: CB to MUB
3/14/2022	4417	Text Amendment	Amending the permissibility of various uses within Table 5-1: Zoning District uses
3/14/2022	4419	Zone Change	Tract 1, H&B Tracts: County MU to AG
3/14/2022	4420	Zone Change	Tracts 20-22, Rocky Mountain Industrial Park Addition Third Filing; and Lots 1-2, Block 1, Rocky Mountain Industrial Park Fifth Filing: CB to HI

**APPENDIX K – AMENDMENTS, CONTINUED**

The following is a log of amendments to this code including text and zoning map amendments. A copy of the official ordinance authorizing the amendments is on file with the City.

<b>DATE</b>	<b>ORD. No.</b>	<b>TEXT AMENDMENT OR ZONE CHANGE</b>	<b>AMENDED SECTIONS OR NEW ZONING DISTRICT</b>
3/28/2022	4423	Text Amendment	Repealing UDC 5.4.7, UU - Urban Use Overlay District, and creating UDC 5.6.9, UU - Urban Use Overlay District
4/11/2022	4425	Text Amendment	Creation of UDC 6.3.10 - Common Landscape Plan and associated definitions
5/9/2022	4432	Zone Change	Lot 1, Block 1, Interior Heights, 4th Filing: AR to Harmony Valley PUD
6/13/2022	4442	Zone Change	Lot 1, Dell Range Marketplace, 3' Filing: MUB to CB
6/27/2022	4449	Zone Change	West Edge District: MUB, MUR, LI, and CB to MUB with the UU Overlay
7/11/2022	4450	Text Amendment	Creation of the definition for Data Center and modification to other Industrial Use definitions. Additions of Data Center and its permissibility to Table 5-1: Zoning District uses
9/12/2022	4457	Zone Change	Lot 1, Block 1 Comea Subdivision, 2nd Filing: LI to CB
9/26/2022	4464	Zone Change	Lots 3 and 4, Block 17 and Lots 1 and 2, Block 16 and all of Moran Avenue adjacent thereto, Frontier Gardens 3fl Filing: HR to CB
9/26/2022	4465	Zone Change	Lot 1 and Lot 1 1/2 , Block 18, Re-subdivision of Lake Minnehaha Addition: MR to NR-2
10/10/2022	4468	Zone Change	SV2 of the SV2 of Tracts 27 & 28 Sunnyside Addition, 2nd Filing plus (Book 1345, Page 800, 8640 square feet) vacated Monroe Avenue between said S'2 SV2 tracts and Cox Subdivision Lot 6, Block 2; and Lots 4 and 5, Block 4, Foxcrest Subdivision: MUB to CB
11/14/2022	4474	Zone Change	A parcel of land being situated in a portion of north half of Section 23, Township 13 North, Range 67 West of the Sixth Principal Meridian: County CB and County A-2 to CB, AG, and LI
12/12/2022	4476	Zone Change	Lot 1, Block I, Pat Griffin Park, Second Filing: P to CB
12/27/2022	4479	Zone Change	North 132' of the east 120' of the east 190' of the SE 1/4 of Tract 36, Hill Heights Addition: County AR to NR-3
12/27/2022	4480	Zone Change	Lot 12-22, Block 720, South Cheyenne: LI to NR-3
1/9/2023	4482	Zone Change	A portion of the NW 1/4 of Section 2, Township 13 North, Range 66 West, of the 6th P.M.: County HI and A-2 to MR
1/9/2023	4484	Zone Change	A portion of the N 1/2 of Section 3, Township 13 North, Range 66 West, of the 6th P.M.: County P to P
2/13/2023	4490	Zone Change	A tract of land in N 1/2 N 1/2 Section 12, Township 13 North, Range 67 West of the 6th P.M.: County LI to LI
3/13/2023	4493	Text Amendment	Amending Section 1.3 soeifically enforcement of the UDC.
3/13/2023	4494	Zone Change	Lot 1, Block 4, Back 40, 3rd Filing: MUB and CB to CB
3/27/2023	4496	Zone Change	Tracts of land situated in portions of Sunnyside Addition and Sunnyside Addition Second Filing, Section 12, t. 13 N., R. 67 W., 6th p.M.: County MU to MUB and CB
4/10/2023	4498	Zone Change	Tract 12 and 13, Mountain View Homes Subdivision: County LR to LR
5/8/2023	4500	Zone Change	Tract 12, Dell Range Addition, a subdivision of part of the west one-half of Section 22, Township 14 North, Range 66 West of the 6th P.M., Laramie County Wyoming less that portion described in warranty deed recorded in Book 1148 Page 1486 and less that portion being the north 120 feet of the east half of Tract 12, Dell Range Addition: County MR to MR
5/8/2023	4501	Zone Change	Lot 1 and 2, Block 1, Twin 22 Subdivision: MR to NR-2
6/12/2023	4506	Zone Change	Lot 29, Block 1, Eastridge
7/10/2023	4511	Zone Change	The south 144.5' of Tract 25, Dell Range Addition: County A-1 to MR

## APPENDIX K – AMENDMENTS, CONTINUED

The following is a log of amendments to this code including text and zoning map amendments. A copy of the official ordinance authorizing the amendments is on file with the City.

DATE	ORD. NO.	TEXT AMENDMENT OR ZONE CHANGE	AMENDED SECTIONS OR NEW ZONING DISTRICT
7/10/2023	4513	Zone Change	The north 497.58' of Tract 227, Sunnyside Addition. 6th Filing: County MR to MR
7/10/2023	4514	Zone Change	A parcel of land being a portion of Tract 25, Dell Range Addition and located in the northwest one-quarter of the northwest one-quarter of Section 22, Township 14 North, Range 66 West of the 6th Principal Meridian: County A-1 to AG
7/10/2023	4515	Zone Change	Lot 14 and 15, Christensen Park: LI to MR
7/10/2023	4516	Text Amendment	Amending section 2.4.2 Annexations and creating section 2.2.8, Assigned Zoning, clarifying city zone assignment processes in concert with annexations and when removing city zone districts.
7/10/2023	4517	Text Amendment	Amending section 2.2.1.C.5 and 2.2.2.C.6 amending protest petitions for zoning map amendments and planned developments.
8/14/2023	4519	Zone Change	Lot 2 and 3, GDC Subdivision: HI, AG, and County A-2 to LI
10/9/2023	4526	Zone Change	Lot 1, Block 1, Back 40 Subdivision, Third Filing: MUB to P
10/9/2023	4527	Zone Change	Lots 3, 4, 5, & 6, Block 1, Hitching Post Plaza, 3rd Filing: CB to MUB
11/27/2023	4530	Zone Change	Lot 2, Block 1, Sunnyside Addition, 10th Filing: MUB to CB
12/11/2023	4532	Zone Change	Lots 1 and 2, Block 8, Whitney Ranch, 4th Filing: CB and HR to MUB
12/11/2023	4534	Assigned Zoning	County Pocket Annexation 2: County Zones to City Zones
12/21/2023	4535	Text Amendment	Amending section 5.1.5 removing the minimum lot area requirements for Lot Types DD5 through DD8, SD1 through SD3, AD1 through AD2, and the MD3.
12/21/2023	4536	Text Amendment	Amending section 5.1.5 removing density requirements for the MD1 through MD3 Lot Types.
12/21/2023	4537	Text Amendment	Amending section 6.2.4 table 6-2, changing the parking requirements for multi-family.
1/8/2024	4538	Text Amendment	Amending section 6.7.5.b, Changing building facade design requirements to reduce windows on Urban Loft Multifamily Residential and Mixed-use Residential Development.
1/8/2024	4541	Assigned Zoning	Tract 2, Polk Addition, 2nd Filing: County AR to AR
1/8/2024	4542	Zone Change	Tract 2, Polk Addition, 2nd Filing: AR to LI
1/8/2024	4543	Text Amendment	Amending section 6.6.3.b.3, 6.7.5.c, and 6.9.3.e, changing building facade design requirements for multifamily residential development.
2/12/2024	4546	Assigned Zoning	Tract 6, Dell Range Addition: County AR to AR
2/12/2024	4548	Assigned Zoning	The Bluff's 12th Filing: County A-1 and LR to AG and LR
2/12/2024	4549	Zone Change	The Bluff's 12th Filing: AG and LR to CB and MR
2/12/2024	4550	Zone Change	Lots 1 and 2, Block 7, Meadowbrooke Park: NB to CB
2/12/2024	4551	Zone Change	A portion of Tract 23, Sunnyside Addition, 2nd Filing: MUB to CB
4/8/2024	4556	Zone Change	Lots 2 through 76, Block 1, Cheyenne Terrace, 2nd Filing: MR to NR-2
4/8/2024	4558	Assigned Zoning	A parcel of land being situated in a portion of sections 9,10, 11, 12, 13, 14, 15, and 16, Township 13 north range 67 west of the 6th principal meridian: County Zones to AG, HI, CB, LR, and MR
4/8/2024	4559	Zone Change	A parcel of land being situated in a portion of sections 9,10, 11, 12, 13, 14, 15, and 16, Township 13 north range 67 west of the 6th principal meridian: AG, HI, CB, LR, and MR to LI and AG
5/13/2024	4560	Zone Change	Lot 2, Block 1, Q-B Subdivision: MUB to CB



**APPENDIX K – AMENDMENTS, CONTINUED**

The following is a log of amendments to this code including text and zoning map amendments. A copy of the official ordinance authorizing the amendments is on file with the City.

<b>DATE</b>	<b>ORD. NO.</b>	<b>TEXT AMENDMENT OR ZONE CHANGE</b>	<b>AMENDED SECTIONS OR NEW ZONING DISTRICT</b>
5/13/2024	4563	Assigned Zoning	A Parcel Of Land Situate In A Portion Of The Southwest Quarter (Sw¼) Northeast Quarter (Ne¼) Southeast Quarter (Se¼) Section 26, T. 14 N., R. 66 W., 6th P.M., Laramie County, Wyoming: County AR to AR
5/13/2024	4566	Assigned Zoning	4204 Dell Range: County MR to MR
5/28/2024	4567	Text Amendment	Amending sections 1.4.3 Defined Terms and 5.8.8 Accessory Buildings, clarifying Detached Buildings.
5/28/2024	4569	Text Amendment	Amending subsections 6.5.4.b.3 Incentives / Bonus, 6.5.4.b.4 Creative Sign Program, and 6.5.8.j Billboards to restructure sign incentives and bonuses by modifying allowances for signs near interstate highways, allowances for shared signs, eliminating the creative sign program, and clarifying applicability of certain billboard allowances.
5/28/2024	4570	Text Amendment	Amending section 5.1.5 to allow up to three stories for detached dwellings, semi-attached dwellings, and attached dwellings.
6/24/2024	4577	Text Amendment	Amending Sectoins 1.4.3 and 2.2.6 to add a minimum of 14 days to temporary uses.
6/24/2024	4578	Text Amendment	Amending Sction 1.4.4.c, Table 5-1, Section 5.7.4 and Table 6-2, changing Child Care regulations.
9/9/2024	4584	Assigned Zoning	A tract of land situate in a portion of the East half of Section 20, T14N. R66W. 6th P.M., Laramie County, Wyoming: County A-1 to AG
9/9/2024	4585	Zone Change	A tract of land situate in a portion of the East half of Section 20, T14N. R66W. 6th P.M., Laramie County, Wyoming: AG to NR-3
9/9/2024	4587	Assigned Zoning	Lots 33 and 34, Sunnyside Addition, 4th Filing, Resub TR 137-140: County MU to MUR
9/9/2024	4588	Zone Change	Lot 1, Block 1, Wyodigs Properties Subdivision: LI to CB
10/14/2024	4590	Text Amendment	Creation of the BP Business Park zone and conforming amendments, as well as correction of references to the SS Support Services District.

## APPENDIX L – RUCAOs AND PUDs

The following is a log of RUCAOs and PUDs. A copy of the official files and ordinances authorizing these developments and districts is on file with the City.

DATE	ORD. No.	PUD OR RUCAO NAME	PUD OR RUCAO	DESCRIPTION
8/2/1984	2820	Redwood Villa	PUD	Replat of a portion of Redmond Addition. Residential subdivision on north side of Dell Range between Townsend & Ogallala.
11/26/1984	2837	Overland Trails	PUD	West of I-25 & W. College Drive. Includes McDonalds, Flying J, hotel, Ridge Equipment & Truck Repair. Other areas subsequently rezoned.
7/3/1985	2878	Silvergate Addition, 2nd Filing	PUD	Residential subdivision & church northeast of East Lincolnway & Pinion Dr.
11/7/1985	2896	Fairway Addition	PUD	Office building at 236 Manewal Dr.
1/7/1986	2916	Silver East Subdivision	PUD	Mixed use five-lot subdivision at northeast corner of N. College Dr. & E. 12th.
5/25/1988	3027	Highland Village	PUD	Amended 1982 Ord. #2645. Residential subdivision northwest of E. Fox Farm Rd & Morrie Ave.
9/23/1994	3237	Frontier Square	PUD	Amended 1982 Ord #2600. Commercial development including Target on the north side Dell Range between Frontier Mall Dr. & Prairie Ave.
5/15/1995	3256	Airport Valley Tracts	PUD	Amended 1987 Ord #2994. Church property at 600 E. Carlson St.
3/19/1997	3294	G&F Diamond Development	PUD	Amended 1984 Ord #2847, 1983 Ord #2732, 1982 Ord #2639. Vacant land at 4200 McCann Ave. & City-owned land along Dry Creek.
5/21/1997	3297	Block 596 Original City	PUD	Amended 1987 Ord #2975. Church at 711 Warren Ave.
6/17/2003	3522	The Victorians	PUD	Small-lot residential on Cobblestone Ct. in 4000 block of N. College Dr.
9/21/2004	3599	Transit Facility	RUCAO	City fleet center at 2617 Old Happy Jack Rd.
9/22/2004	3597	Harmony Meadows, 2nd Filing	PUD	Residential subdivision at the southwest corner of Allison Rd. & Walterscheid.
8/27/2005	3664	Cheyenne Street Four-plexes	PUD	Four-plexes at northeast corner of Cheyenne St. & N. College Dr.
10/15/2005	3670	College Business Park	PUD	Commercial business park at northeast corner of Laramie St. & N. College Dr.
9/16/2006	3724	Frontier Mall	PUD	Amended 1991 Ord. 3132, which amended 1979 Ord #2278.
12/16/2006	3732	Paul A. Smith Manor	PUD	Residential & office in Lakeview Historic District on north side E. 25th between Van Lennen & Maxwell Ave.
2/16/2007	3741	The Village	PUD	Mixed-use development on Old Town Ln. between Sycamore & Powderhouse.
12/31/2007	3783	Life Care Center	PUD	Assisted living center at 1330 & 1406 Prairie Ave.
12/13/2008	3835	JL Ranch	PUD	Residential subdivision & church on HR Ranch Rd. west of Burlington Trail.
1/16/2009	3839	South Park Estates	RUCAO	South Park Estates, 6th Filing, north of I-80 between Walterscheid & Stanfield.
2/14/2009	3841	Pointe Plaza	PUD	Mixed-use development, west side Powderhouse north & south of Spirit Ln.
6/13/2009	3850	Storey Acres, 2nd Filing	PUD	Commercial subdivision, south side Storey between Sunset & Townsend Pl.
4/16/2010	3886	Block 140A	PUD	State-owned parking lot bound by Warren, 24th, Central, & 25th.
10/18/2011	3931	Hospital Center, 1st Filing	PUD	Cheyenne Regional Medical Center, east side Warren north & south of 24th.
12/17/2011	3938	Mountview Park, Block 5	PUD	Safeway, formerly Cole Shopping Center, southeast corner of Converse & E. Pershing Blvd.
8/19/2013	3989	Swan Ranch II Annexation	PUD	Industrial Rail Park, west side Clear Creek Pkwy. north of Tundra.
10/14/2016	4154	Pump House RUCAO	RUCAO	Original City, Pumphouse Park south of W. Lincolnway, east of Ames Ave.
4/14/17	4173	Sunflower PUD	PUD	BEAST Program at 2900 Sunflower Road. Amended by Ord. #4198 (effective 9/16/2017) to allow wireless antennas as an admin use.
6/23/2018	4232	Sweetgrass PUD	PUD	Large-scale mixed-use development south of LCCC (over 2,000 acres).

